

2021

# DECENTRAL DOMESTIC VENTILATION

PRODUCT GUIDE

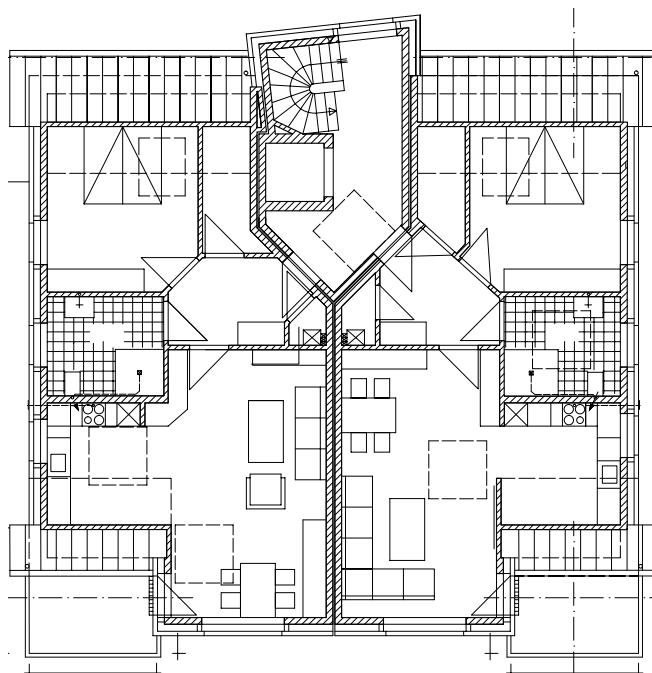

## CONTENT

Decentral domestic ventilation .....	3
Your ventilation proposal .....	3
Operating principle.....	4
Complete solutions for residential construction .....	4
Solutions for special requirements.....	5
VENTO Expert A50-1 S10 W V.2 / VENTO Expert A50-1 Pro .....	6
VENTO Expert DUO A30-1 S10 W V.2 / VENTO Expert DUO A30-1 Pro .....	8
FRESHBOX 100 WiFi - with additional exhaust spigot for a second room.....	10
Cabrio Base – Extract fan.....	16
Quatro C – Extract fan.....	16
Valeo-BP / Valeo-E – Extract fan for internal exhaust air rooms .....	17
Valeo2 – Extract fan for internal exhaust air rooms with fire protection .....	18
CIVIC EC DB / LB – Short excursion to office and school ventilation.....	20
Complementary and alternative accessories .....	24
Sensors .....	26
Solutions for the outside.....	27

# DECENTRAL DOMESTIC VENTILATION



Residential premises have to be ventilated regularly. As trivial this statement may sound as comprehensive are the related consequences. It is not only about sufficient supply of fresh air. Numerous legal regulations pose higher demands on the ventilation of buildings and on ventilation systems in general.

Single-family house or apartment building, a ventilation system has to be taken into account already in the planning stage. We offer our support in finding the suitable ventilation concept for your individual construction project. In addition to our top selling ventilation systems, we provide complementary products like extract fans and a large range of accessories, so you can have it all from one source.

We will be happy to provide you with a ventilation proposal for your project. Please write an email with the floor plans and the relevant details to [info@blaubergventilatoren.de](mailto:info@blaubergventilatoren.de).

## YOUR VENTILATION PROPOSAL

The documents shown are:

- Technical Specification:** "Lüftungsauslegung mit Wärmerückgewinnung nach Din 1946-6". It includes project details like "Projekt", "Anschluß", and "Gebäudedaten".
- Calculation Table:** A table with columns for "Luftwechsel" and "Drehzahl". It contains numerical data for different zones.
- Technical Drawing:** A diagram showing a floor plan with ventilation points labeled "Blk 1", "Blk 2", "Blk 3", and "Blk 4".
- Certificate of Approval:** A document with the heading "Attestnummer" and a table for "Lüftungswerte".

## OPERATING PRINCIPLE

Our decentral ventilation system is perfectly suited for the renovation of old buildings as well as for new buildings, where complex ductwork is undesired. Our units are operating in pairs, they change the air flow direction every 70 seconds and perform an air exchange rate up to 100 m<sup>3</sup>/h in total. They are pressure-neutral in pairs. A ceramic enthalpy heat exchanger ensures efficient heat recovery. By means of a core hole (for existing buildings)

the units are built into the wall. For new buildings one can also use a shell installation block. This is a block made of expanded polystyrene, with a ready-made opening for the ventilation duct. The block is installed into the wall during shell construction phase and no core hole is needed later. The decentral units have the advantage of easy installation and economical maintenance.

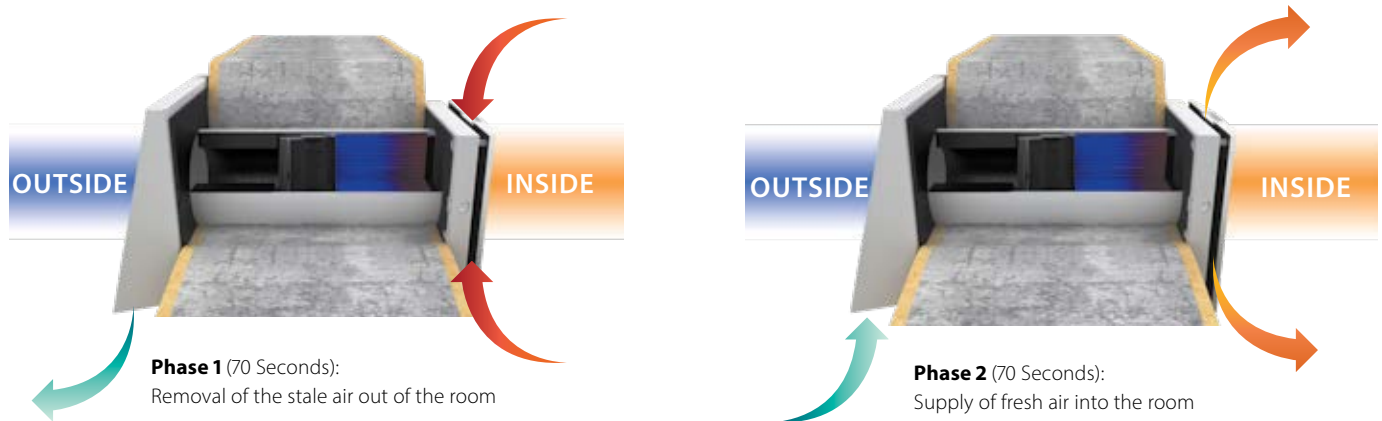

## COMPLETE SOLUTIONS FOR RESIDENTIAL CONSTRUCTION

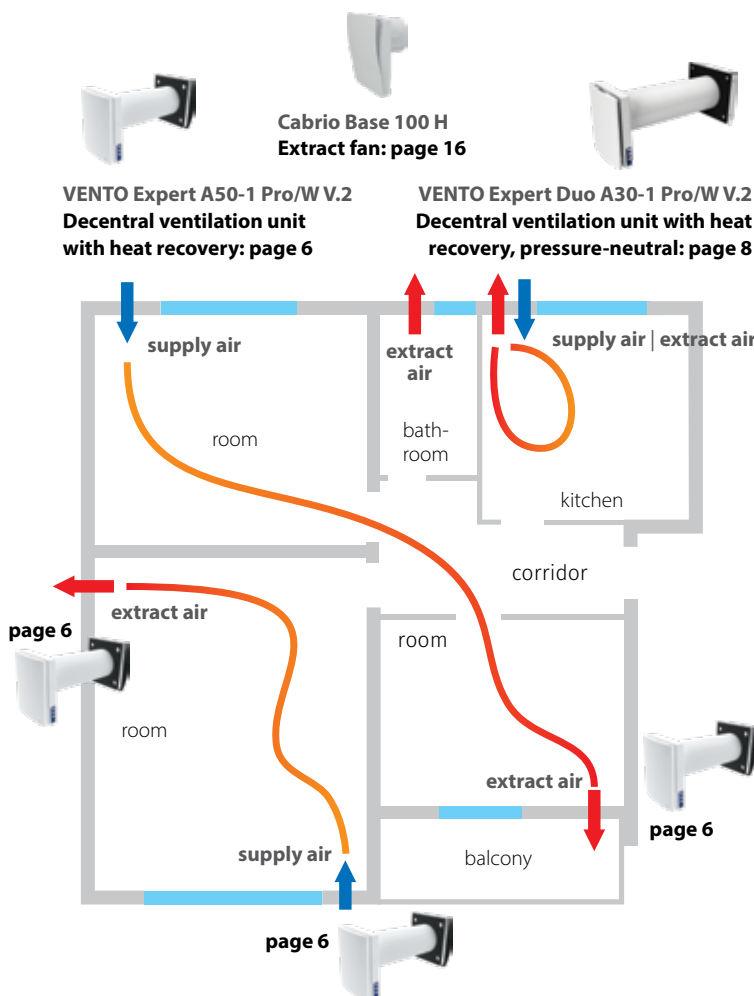

Diagram of a possible ventilation for a three-room apartment

### EXEMPLARY VENTILATION CONCEPT FOR A THREE-ROOM APARTMENT

By means of a typical floor plan for rental apartments we would like to show you how to utilise a decentral ventilation. As an example we have a three-room apartment with rooms of 12 – 25 m<sup>2</sup> and a ceiling height of ca. 2.5 m. In this case we installed four VENTO Expert A50-1 (Pro/W), one VENTO Expert Duo A30-1 (Pro/W) and a typical extract fan, e.g. the shapely, low-noise Sileo Design.

The two smaller rooms are ventilated by a pair of VENTO Expert A50-1. This works perfectly when the two rooms are used at a similar intensity, for example, when both rooms are used as bedrooms. The larger room was equipped with two VENTO Expert A50-1. It can be ventilated independently of the other rooms.

The kitchen and the bathroom have to be considered separately from the remaining apartment, as increased humidity and odours occur in these rooms. In our example, for the kitchen the pressure-neutral VENTO Expert Duo A30-1 (Pro/W) is utilised. It works independently and transports humidity and odours directly outside. VENTO Expert Duo A30-1 is also a solution for bathrooms, especially if governmental subsidy is to be obtained for providing a high heat recovery rate and thus saving energy. For very small rooms or to save costs, one often resorts to extract fans without heat recovery. It is worth taking a closer look and analyse the needs and budget individually.

#### REQUIRED UNITS:

4 VENTO EXPERT A50-1 PRO/W V.2	PAGE 6
1 VENTO EXPERT DUO A30-1 PRO/W V.2	PAGE 8
1 EXTRACT FAN – CABRIO BASE/QUATRO C	PAGE 16

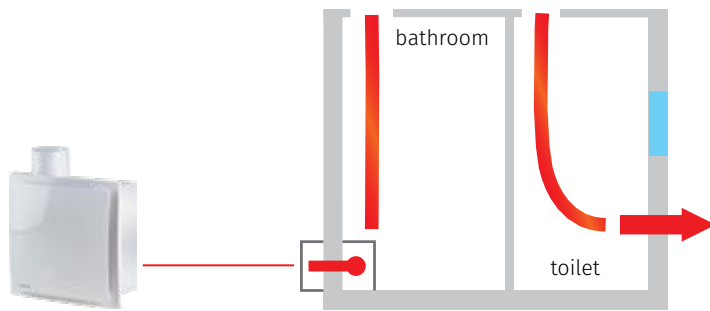

**VALEO-BP: Fan and casing for flush mounting, see page 19**

According to DIN 18017-3, the installation of a radial extract fan is mandatory for internal bathrooms.

## VENTILATION OF BATHROOMS WITH NO OUTER WALL

In an apartment, it is not always possible to ventilate every room through an outer wall. For internal bathrooms, we offer a concept for ventilation according to DIN 18017-3. Valeo-BP 35/60 H is an extract fan with humidity sensor for internal rooms. It removes the humid air via a duct system through the roof. Valeo provides a useful complement to a decentral ventilation system.

For more details, see page 17.

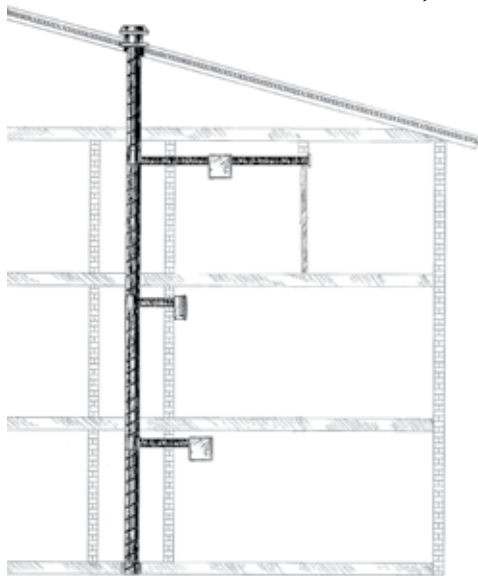

The diagram shows different installation options for Valeo.

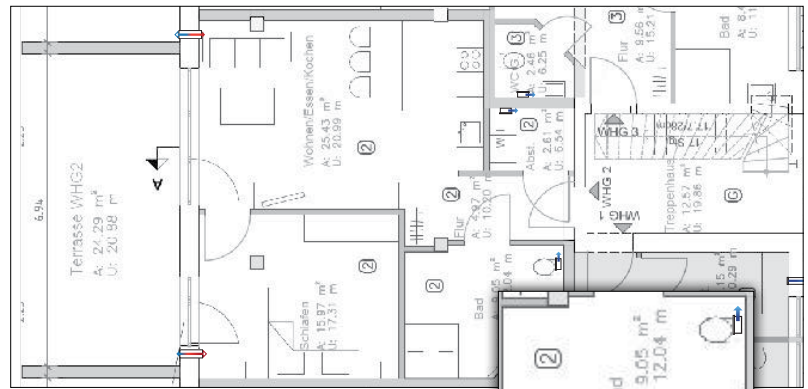

Part of a ventilation proposal for an apartment building with internal bathrooms and toilets.

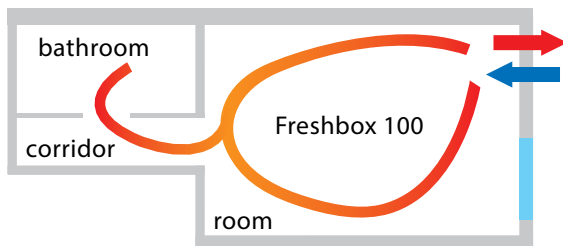
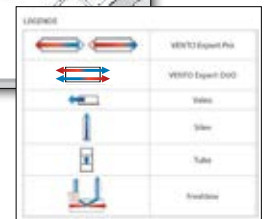

## APARTMENT VENTILATION – SUITABLE FOR METROPOLITAN AREAS

Freshbox 100 WiFi is particularly suitable for studio apartments, because it is possible to ventilate a second room with a simple duct system. Due to the high air flow rate of 100 m<sup>3</sup>/h and a remarkable heat recovery rate up to 98 % this unit is also very suitable for offices.

Product data and information about the extra connection for the ventilation of a second room from page 14.

## SOLUTIONS FOR SPECIAL REQUIREMENTS

### VENTILATION SOLUTIONS FOR BASEMENTS AND ROOFS

There are diverse installation circumstances which require special accessories, for example, when the area to be ventilated is located in the basement or below the roof of a residential building. For such cases, we provide basement or roof penetration ducts for our extract fans and VENTO Expert A50-1 Pro/W which can be installed instead of an outer hood. The basement penetration includes a duct with a condensation drain and a ventilation cap from stainless steel.

The roof penetration consists of a duct, a condensate drain and a hood which can be adapted in colour to the roof shingles. There are various colours available.

For more information, please see pages 25 and 26.

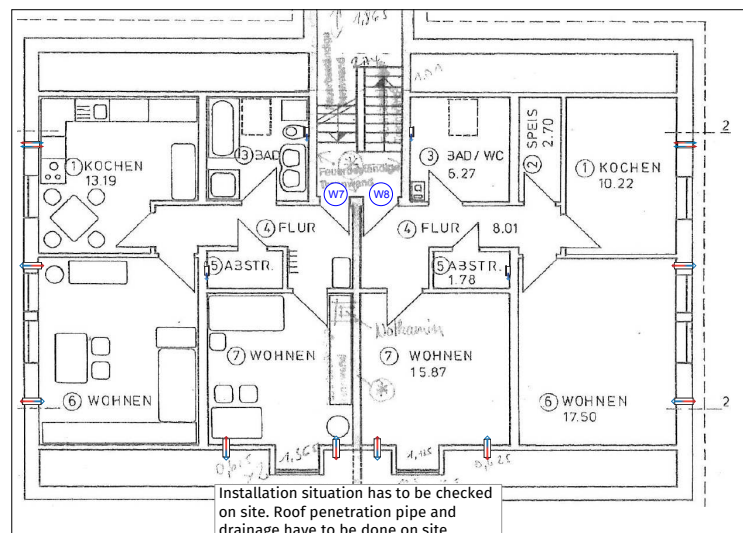



# VENTO EXPERT A50-1 S10 W V.2

Heat recovery single-room units

## Features

- o Arrangement of efficient energy-saving, supply and exhaust, single-room ventilation in apartments, houses, cottages, social and commercial premises.
- o Reducing heat losses caused by ventilation due to heat recovery.
- o Humidity balance and controllable air exchange create individually controllable microclimate.
- o Wi-Fi data exchange between several single-room ventilation units for coordinated operation.
- o Controllable by Android or iOS smartphone or tablet.

**Air flow:**  
up to 50 m<sup>3</sup>/h  
14 l/s

**Heat recovery efficiency:**  
up to 93 %

**Power:**  
from 4.45 W

**Noise level:**  
from 11 dBA



# VENTO EXPERT A50-1 Pro

The VENTO Expert is also available without a Wi-Fi antenna. In this case, the units have to be connected via cable and are controlled by the remote control or the buttons on the unit. Apart from that all technical data are identical. The complete unit is delivered with a metal outer hood.

<b>Product name</b>	VENTO Expert A50-1 Pro (metal hood)
<b>Article number</b>	8022999
<b>Discount group</b>	R005
<b>List price</b>	734.00 €



## Design

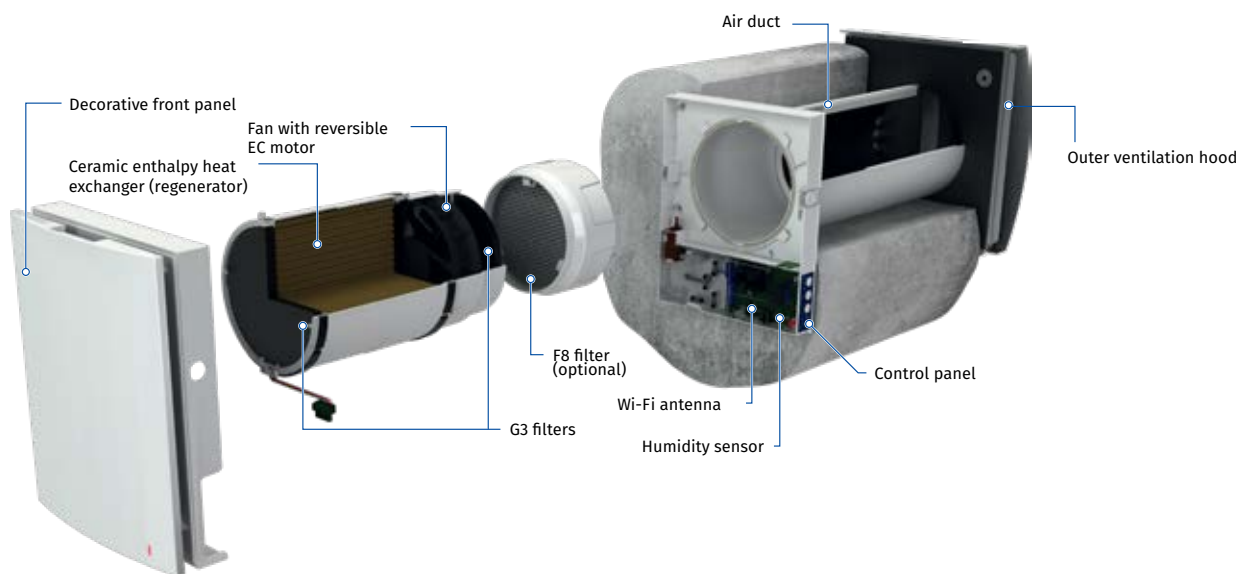

## Mounting

- o The unit is designed for through-the-wall installation inside a prepared hole in an outer wall of the building.
- o The best ventilation solution is pairwise installation of reverse phase synchronized units. Some units ensure supply of fresh air to the room and the other units extract air from the premise. This way the most efficient balanced ventilation is arranged.
- o In case of brand new construction, units are mounted in two stages:
  - **Pre-installation** of an air duct and an outer ventilation hood at the stage of indoor finishing and outer decorative wall finishing.
  - **Completion of the installation** before completion of the house. It includes installation of the indoor unit with controller and shutters the cartridge, the heat exchanger, the fan and the filters.

## Designation key

Model	Air duct	Rated air flow [m <sup>3</sup> /h]	Front panel	Ventilation hood type	Control
VENTO Expert	A: round air duct	50	-1: flat front panel	S10: white plastic hood AH-10 white 160 (for standard walls) S: metal hood (for thin walls)	W V.2: Control and setup of the unit with the Wi-Fi mobile application

### Control

- Unit control via smartphone or tablet application.
- The units can be connected by Wi-Fi for synchronized operation.
- House ventilation control via cloud service from anywhere in the world.
- Connection to smart house or Building Management System (BMS) via Wi-Fi.

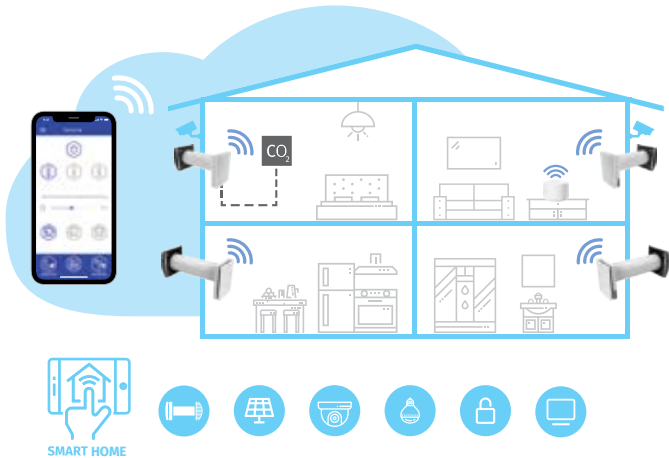

- Vento Expert A50-1 S10 W V.2** either can operate as independent unit or can be connected with other units in a house and controlled with a master unit. In this case, only the master unit receives a signal from the remote control.

#### FOR LIVING ROOMS AND BEDROOMS



#### FOR KITCHEN AND BATHROOM



- Blauberg Vento V.2** app for Android or iOS devices is available at Google Play and App Store.



Download the **Blauberg Vento V.2** app for Android



Download the **Blauberg Vento V.2** app for iOS

- Vento Expert A50-1 S10 W V.2** is equipped with a humidity sensor for indoor humidity control. If humidity increases above a set point, the unit boosts to speed III.

### Project information

It is possible to order the decentral units separately as pre-installation kit (ventilation duct and outer hood) and completion kit (interior part and cartridge).

This is cost-efficient, saves storage place and minimises the risk of parts not needed until the final phase of the construction project being damaged at the construction site.

For detailed price information, please request our bestseller price list at [info@blaubergventilatoren.de](mailto:info@blaubergventilatoren.de).

### Technical data

Parameters	VENTO Expert A50-1 S10 W V.2		
	I	II	III
Speed			
Voltage [V / 50 (60) Hz]	100–230		
Power [W]	4.45	5.08	7.06
Current [A]	0.035	0.040	0.059
RPM [min <sup>-1</sup> ]	800	1300	1900
Air flow in ventilation mode [m <sup>3</sup> /h (l/s)]	15 (4)	30 (8)	50 (14)
Air flow in energy recovery mode [m <sup>3</sup> /h (l/s)]	8 (2)	15 (4)	25 (7)
SFP [W/l/s]	2.14	1.22	1.02
Filter	G3 (Option: F8 PM2.5 > 99 %*)		
Transported air temperature [°C]	-20 to +40		
Sound pressure level at 1 m in accordance with ISO 3741:2004 [dBA]	20	27	30
Sound pressure level at 3 m in accordance with ISO 3741:2004 [dBA]	11	18	21
Outdoor sound pressure attenuation in accordance with DIN EN 20140 [dBA]	42		
Heat recovery efficiency in accordance with DIBt LÜ-A 20 [%]	up to 93		
Ingress protection rating	IP24		

\* maximum air flow 40 m<sup>3</sup>/h

### Overall dimensions [mm]

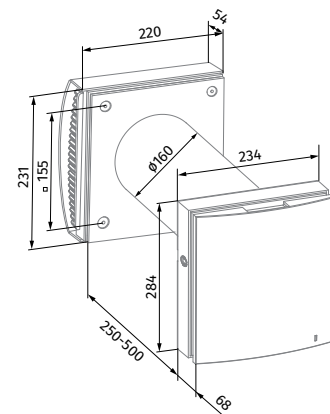

<b>Product name</b>	VENTO Expert A50-1 S10 W V.2 (plastic hood)
<b>Article number</b>	8053474
<b>Discount group</b>	R005
<b>List price</b>	793.00 €

# VENTO EXPERT DUO A30-1 S10 W V.2

Heat recovery single-room units

## Features

- Arrangement of balanced energy saving, supply and exhaust, single-room ventilation in kitchen, bathroom and utility room.
- Reducing heat losses caused by ventilation due to heat recovery.
- Humidity balance and controllable air exchange create individually controlled micro-climate.
- Wi-Fi data exchange between several single-room ventilation units for coordinated operation.
- Controlled by Android or iOS smartphone or tablet.
- NEW: with week timer and operating hours counter



**Air flow:**  
up to 30 m<sup>3</sup>/h  
8 l/s



**Heat recovery efficiency:** up to 85 %



**Power:**  
up to 2.17 W



**Noise level:**  
up to 24 dBA



## VENTO EXPERT DUO A30-1 Pro

The VENTO Expert is also available without a Wi-Fi antenna. In this case the units have to be connected via cable and are controlled by the remote control or the buttons on the unit. Apart from that all technical data are identical. The complete unit is delivered with a metal outer hood.

Product name	VENTO Expert DUO A30-1 Pro (metal hood)
Article number	8027659
Discount group	R005
List price	850.00 €



## Design



- Speed selection / OFF
- Heat recovery mode
- Ventilation mode
- Filter Alarm Master

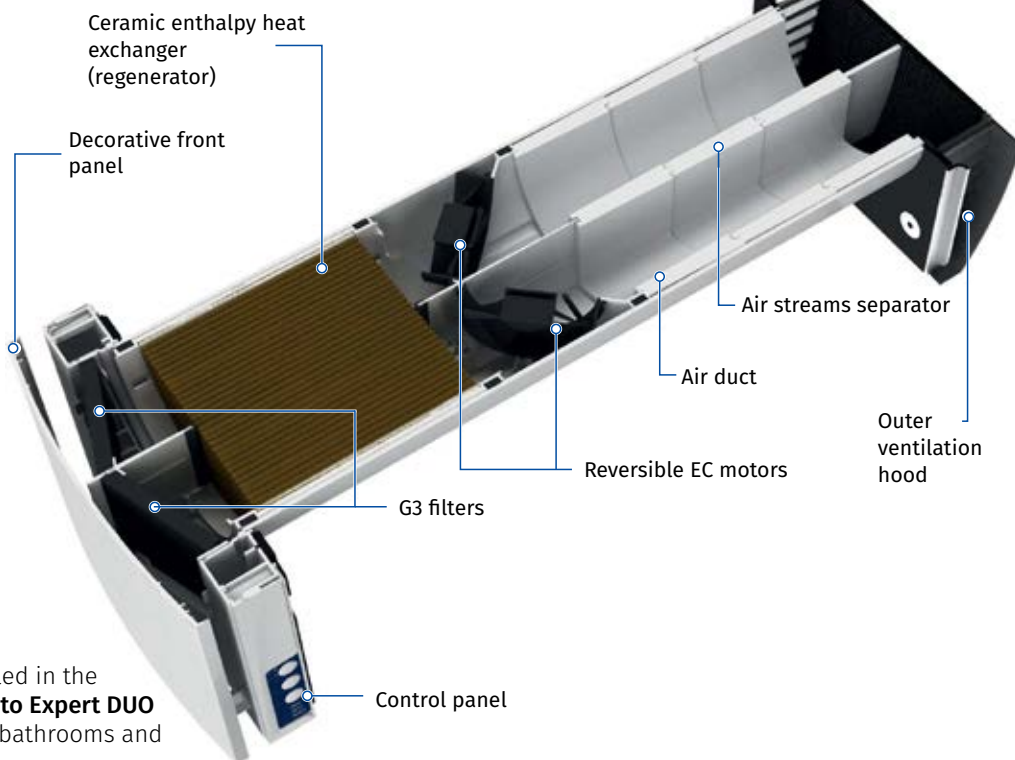

## Mounting

- **VENTO Expert** units should be installed in the living room and bedrooms while **Vento Expert DUO** units should be installed in kitchen, bathrooms and utility room.
- The unit is designed for through-the-wall installation inside a prepared hole in an outer wall of the building.

## Designation key

Model	Fans	Air duct	Rated air flow [m <sup>3</sup> /h]	Front panel	Ventilation hood type	Control
VENTO Expert	Duo: two fans with different rotation direction	A: round air duct	30	-1: flat front panel	S10: white plastic hood AH-10 white 160 Duo	W V.2: control and setup of the unit with the Wi-Fi mobile application



### Control

- Unit control via smartphone or tablet application.
- The units can be connected by Wi-Fi for synchronized operation.

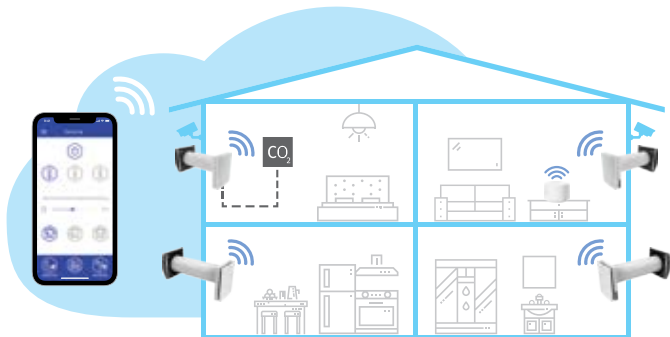

- Blauberg Vento V.2** app for Android or iOS devices is available at Google Play and App Store.



Download the **Blauberg Vento V.2** app for Android



Download the **Blauberg Vento V.2** app for iOS

- House ventilation control via cloud service from anywhere in the world.
- Connection to smart house or Building Management System (BMS) via Wi-Fi.

### FOR LIVING ROOMS AND BEDROOMS



VENTO Expert A50-1 S10 W V.2

### FOR KITCHEN AND BATHROOM



VENTO Expert DUO A30-1 S10 W V.2

- VENTO Expert DUO A30-1 S10 W V.2** is equipped with a humidity sensor for indoor humidity control. If humidity increases above a set point, the unit boosts to the speed III.

### Project information

It is possible to order the decentral units separately as pre-installation kit (ventilation duct and outer hood) and completion kit (interior part and cartridge).

This is cost-efficient, saves storage place and minimises the risk, that parts, which are not needed until the final phase of the construction project, are damaged at the construction site.

For detailed price information please request our bestseller price list at [info@blaubergventilatoren.de](mailto:info@blaubergventilatoren.de).

### Technical data

Parameters	VENTO Expert DUO A30-1 S10 W V.2		
	I	II	III
Speed			
Voltage [V / 50 (60) Hz]		100-230	
Power [W]	2.17	3.66	6.62
Current [A]	0.026	0.039	0.066
RPM [min <sup>-1</sup> ]	1600	2200	2500
Air flow in ventilation mode [m <sup>3</sup> /h (l/s)]	10 (3)	20 (6)	30 (8)
Air flow in energy recovery mode [m <sup>3</sup> /h (l/s)]		60 (16)	
SFP [W/l/s]	0.78	0.66	0.79
Filter		G3	
Transported air temperature [°C]		-15...+50	
Sound pressure level at 1 m in accordance with ISO 3741:2004 [dBA]	33	40	43
Sound pressure level at 3 m in accordance with ISO 3741:2004 [dBA]	24	31	34
Outdoor sound pressure attenuation in accordance with DIN EN 20140 [dBA]		42	
Heat recovery efficiency in accordance with DIBt LÜ-A 20 [%]		up to 85	
Ingress protection rating		IP24	

### Overall dimensions [mm]

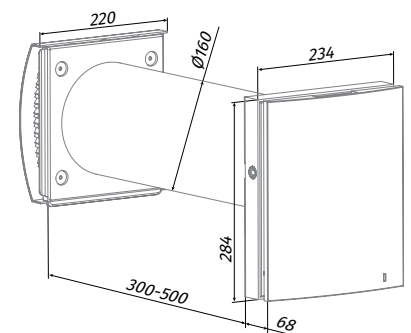

<b>Product name</b>	VENTO Expert DUO A30-1 S10 W V.2 (plastic outer hood)
<b>Article number</b>	8053481
<b>Discount group</b>	R005
<b>List price</b>	898.00 €

# FRESHBOX 100 WiFi

## Single-room air handling units

### Features

- Efficient solution for supply and exhaust ventilation of enclosed spaces
- Electric preheater or reheater modification available for cold climate conditions
- Heat exchanger with an enthalpy membrane modification available for humid and hot climate conditions.
- Low-energy EC motors
- Silent operation
- Upgradeable with an exhaust duct to provide air extraction from the bathroom
- Easy installation
- Compact size
- Controlled by Android or iOS smartphone or tablet via Wi-Fi



**Air flow:**  
up to 100 m<sup>3</sup>/h



**Heat recovery efficiency:**  
up to 96 %



### Design

- Polymer coated metal casing decorated with an acrylic front panel. Heat and noise insulation is ensured by a layer of 10 mm cellular synthetic rubber.
- The front panel provides convenient access for filter maintenance and has a lock for extra security.
- The unit has two Ø 100 mm pipes for fresh air intake and stale air extraction outside. The third Ø 100 mm pipe (included in the scope of delivery) can be additionally fitted to the unit to connect the exhaust air duct from the bathroom.

### Motors

- The units feature efficient electronically commutated (EC) motors with an external rotor and impellers with forward curved blades. These state-of-the-art motors are the most advanced solution in energy efficiency today.
- EC motors are characterised with high performance and optimum control across the entire speed range. In addition to that the efficiency of electronically commutated motors reaches very impressive levels of up to 90 %.

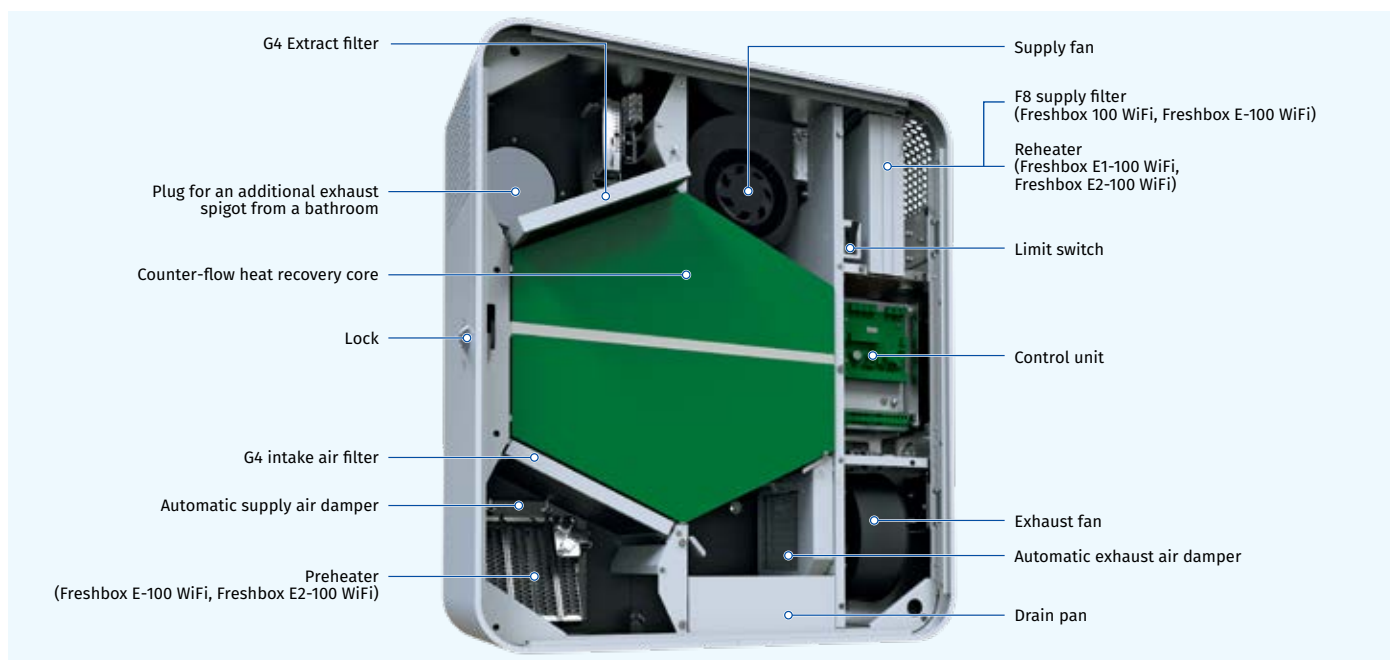

### Designation key

Series	Heater	Rated air flow [m <sup>3</sup> /h]	Heat exchanger core type	Control
Freshbox	_: no heater E: preheating E1: reheating* E2: preheating and reheating*	100	_: heat recovery ERV: energy recovery	WiFi: sensor control panel and Wi-Fi communication

\*Freshbox 100 WiFi E1 and E2 cannot be combined with supply air filter F8

### Air dampers

- The unit is equipped with supply and exhaust air dampers which activate automatically to prevent drafts while the unit is off.

### Air filtration

- **Freshbox 100 WiFi, Freshbox E-100 WiFi:** supply air cleaning is provided by the G4 and F8 filters. To meet more stringent air purity requirements the F8 filter can be replaced with an H13 or F8 carbon filter (purchased separately). Exhaust air is cleaned by a G4 filter.
- **Freshbox E1-100 WiFi, Freshbox E2-100 WiFi:** the built-in G4 supply filter and G4 extract filter provide air filtration.

### Operating principle

- **The cold outdoor air** passes through the filters and the heat exchanger and then is delivered to the serviced space by the supply centrifugal fan.
- **Warm stale air from indoors** passes through the filter and the heat exchanger and is discharged outdoors by the centrifugal fan.
- **The supply and exhaust air** flows are fully separated which helps eliminate the possibility of odour or microbial transfer between the streams.

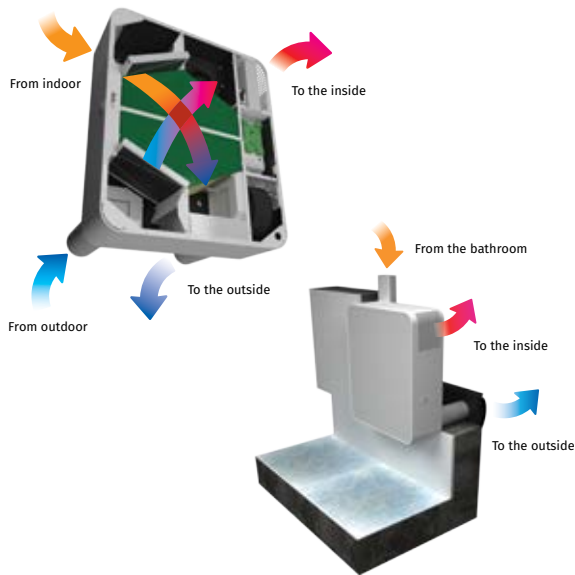

Operating principle with extra spigot for bathroom exhaust ventilation

### Heat and energy recovery

- The **Freshbox 100 WiFi** units are equipped with a counter-flow heat recovery core from polystyrene.
  - **In the cold season** the exhaust air heat is captured and transferred to the supply air stream which reduces the ventilation-generated heat losses. Some condensate may form during heat recovery. The condensate is collected in the drain pan and is removed from the exhaust air duct.
  - **In the warm season** the intake air heat is transferred to the extract air stream. This allows for a considerable reduction of the supply air temperature which, in turn, reduces the air conditioning load.

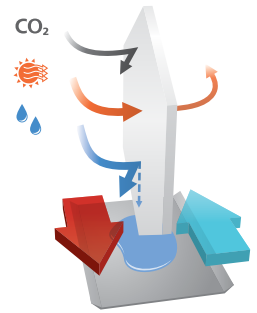

- The **Freshbox 100 ERV WiFi** units are equipped with a counter-flow energy recovery core with an enthalpy membrane at the core.
  - **In the cold season** the exhaust air heat and moisture are transferred to the supply air stream through the enthalpy membrane reducing the heat losses through ventilation.
  - **In warm season** the heat and humidity of the outdoor air is absorbed by extract air flow through the enthalpy membrane. This way the supply air temperature and humidity decreases and heat recovery reduces operation loads for the air conditioner.

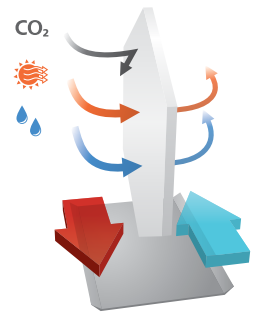

### Heaters

#### PREHEATING

- **Freshbox E-100 WiFi, Freshbox E2-100 WiFi** units are equipped with an electric preheater for freeze protection of the heat exchanger.

#### REHEATING

- **Freshbox E1-100 WiFi, Freshbox E2-100 WiFi** units feature an electric reheater to raise the supply air temperature as necessary.

### Freeze protection

- **Freshbox 100 WiFi** features an exhaust air temperature sensor down-stream of the heat exchanger which disables the supply fan to let the warm extract air warm up the heat exchanger. After that the supply fan is turned on and the unit reverts to the normal operation mode.
- Overheating protection for **Freshbox E-100 WiFi** and **Freshbox E2-100 WiFi** is implemented with a preheater.

### Overall dimensions [mm]

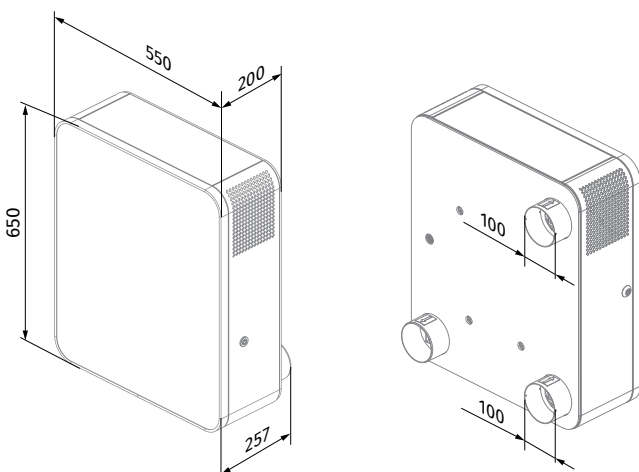

### Control

- The unit is equipped with a control panel.
- The remote control is supplied as standard.
- Wi-Fi communication



Download Android application **Blauberg Freshbox**



Download iOS application **Blauberg Freshbox**

### AUTOMATIC FUNCTIONS

	Freshbox 100 WiFi Freshbox E-100 WiFi	Freshbox E1-100 WiFi Freshbox E2-100 WiFi
Speed selection	•	•
Filter replacement indication	•	•
Alarm indication	•	•
Speed setup	•	•
Timer	•	•
Week scheduler	•	•
Reheater enabled/disabled		•
Supply air temperature setup		•
Control with the mobile application Android / iOS	•	•

### REMOTE CONTROL

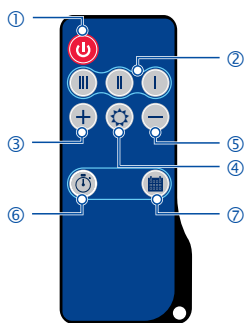

- 1 Turning unit on/off
  - 2 Speed selection (Min/Mid/Max)
  - 3 Increasing temperature set point for the reheater\*
  - 4 Turning reheater on/off\*
  - 5 Decreasing temperature set point for the reheater\*
  - 6 Turning timer on/off
  - 7 Activation/deactivation of the scheduled operation mode
- \*available for the models with a reheater

### CONTROL PANEL

- ON/OFF button
- Speed changeover (down)
- Speed changeover (up)
- Switch on/off of the reheater
- Weekly schedule
- Connection to Wi-Fi
- Filter replacement indication
- Alarm indication

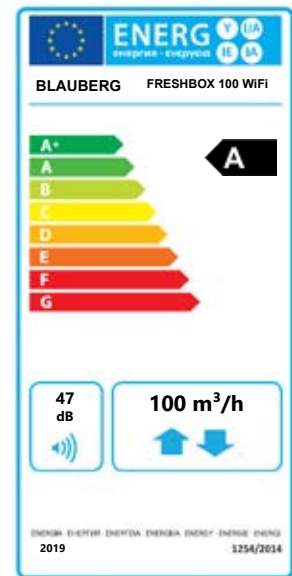

**Technical data**

	Freshbox 100 WiFi					Freshbox 100 ERV WiFi					Freshbox E-100 WiFi					Freshbox E-100 ERV WiFi				
Speed	I	II	III	IV	V	I	II	III	IV	V	I	II	III	IV	V	I	II	III	IV	V
Voltage [V / 50 (60) Hz]	1~110-240										1~230									
Max. power without heater(s) [W]	20	23	29	37	53	20	23	29	37	53	20	23	29	37	53	20	23	29	37	53
Preheater power consumption [W]	-					-					700					700				
Reheater power consumption [W]	-					-					-					-				
Max. current consumption without heater(s) [A]	0.4																			
Max. current consumption with heater(s) [A]	-					-					3.6					3.6				
Maximum air flow [m³/h (l/s)]	30 (8)	44 (12)	60 (17)	75 (21)	100 (28)	30 (8)	44 (12)	60 (17)	75 (21)	100 (28)	30 (8)	44 (12)	60 (17)	75 (21)	100 (28)	30 (8)	44 (12)	60 (17)	75 (21)	100 (28)
RPM [min <sup>-1</sup> ]	max. 2200																			
Sound pressure level at 3 m [dBA]	13	20	27	33	39	13	20	27	33	39	13	20	27	33	39	13	20	27	33	39
Transported air temperature [°C]	-15 to +40																			
Casing material	polymer coated steel																			
Insulation thickness [mm]	10																			
Extract filter	G4																			
Supply filter	G4 + F8 (Option: F8 Carbon; H13)																			
Connected air duct diameter [mm]	100																			
Weight [kg]	31																			
Heat recovery efficiency [%]*	98	95	92	90	89	96	94	89	85	83	98	95	92	90	89	96	94	89	85	83
Heat recovery core type	counter-flow																			
Heat exchanger material	polystyrene					enthalpy membrane					polystyrene					enthalpy membrane				
SEC class	A																			
Article number	8044861					8050510					8050503					8050121				
Discount group	R005					R005					R005					R005				
List price	1.820.00 €					1.970.00 €					1.920.00 €					2.080.00 €				

	Freshbox E1-100 WiFi					Freshbox E1-100 ERV WiFi					Freshbox E2-100 WiFi					Freshbox E2-100 ERV WiFi				
Speed	I	II	III	IV	V	I	II	III	IV	V	I	II	III	IV	V	I	II	III	IV	V
Voltage [V / 50 (60) Hz]	1~230																			
Max. power without heater(s) [W]	20	23	29	37	53	20	23	29	37	53	20	23	29	37	53	20	23	29	37	53
Preheater power consumption [W]	-					-					700					700				
Reheater power consumption [W]	-										350									
Max. current consumption without heater(s) [A]	0.4																			
Max. current consumption with heater(s) [A]	1.94										5.2									
Maximum air flow [m³/h (l/s)]	30 (8)	44 (12)	60 (17)	75 (21)	100 (28)	30 (8)	44 (12)	60 (17)	75 (21)	100 (28)	30 (8)	44 (12)	60 (17)	75 (21)	100 (28)	30 (8)	44 (12)	60 (17)	75 (21)	100 (28)
RPM [min <sup>-1</sup> ]	max 2200																			
Sound pressure level at 3 m [dBA]	13	20	27	33	39	13	20	27	33	39	13	20	27	33	39	13	20	27	33	39
Transported air temperature [°C]	-15 to +40																			
Casing material	polymer coated steel																			
Insulation thickness [mm]	10																			
Extract filter	G4																			
Supply filter	G4																			
Connected air duct diameter [mm]	100																			
Weight [kg]	31																			
Heat recovery efficiency [%]*	98	95	92	90	89	96	94	89	85	83	98	95	92	90	89	96	94	89	85	83
Heat recovery core type	counter-flow																			
Heat exchanger material	polystyrene					enthalpic membrane					polystyrene					enthalpic membrane				
SEC class	A																			
Article number	8050947					8050954					8050961					8050978				
Discount group	R005					R005					R005					R005				
List price	1920.00 €					2080.00 €					1970.00 €					2130.00 €				

\*Heat recovery efficiency is specified in compliance with EN 13141-8.

Sound-power level, A-weighted	Total	Octave frequency band [Hz]								Sound pressure level at 3 m, A-filter applied	Sound pressure level at 1 m, A-filter applied
		63	125	250	500	1000	2000	4000	8000		
LwA to environment [dBA]	49	45	40	44	38	33	29	27	22	28	38



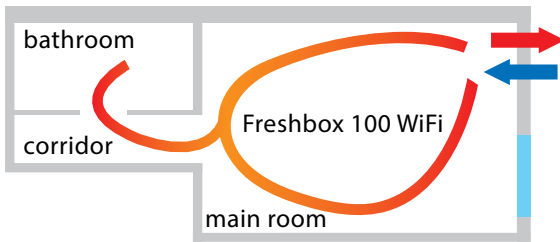

**Apartment ventilation**

**Suitable for metropolitan areas**

Freshbox 100 WiFi is particularly suitable for studio apartments, because it is possible to ventilate a second room with a simple duct system. Due to the high air flow rate of 100 m<sup>3</sup>/h and a remarkable heat recovery rate up to 98 % this unit is also very suitable for offices.

An additional duct can be connected to the Freshbox 100 WiFi to exhaust the air of the bathroom. The ventilation unit has to be equipped with an additional exhaust spigot (included in the delivery) with a diameter of 100 mm therefor.

**Mounting example**

- Each space requiring ventilation is equipped with one or several Freshbox 100 WiFi units.
- A single unit is capable to ensure efficient ventilation in spaces with floor area up to 75 m<sup>2</sup>.

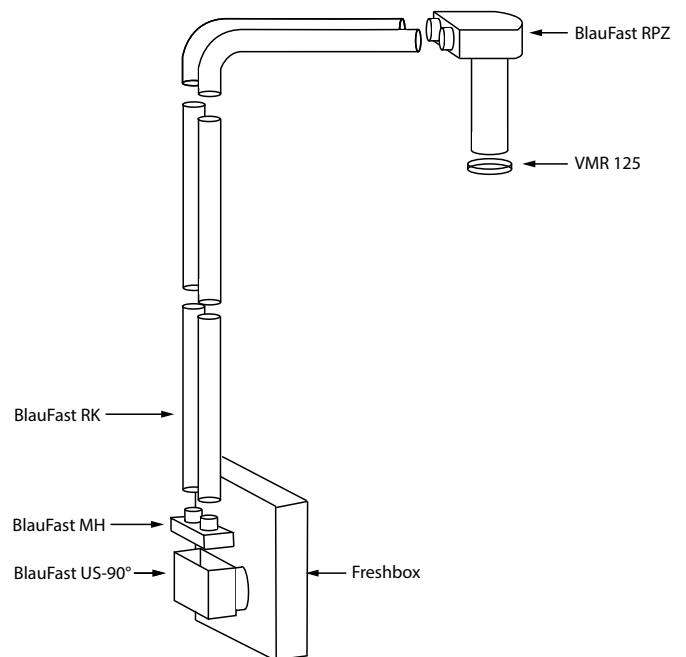

**Freshbox 100 WiFi – Connection for a second room**

The Freshbox 100 models can ventilate an additional exhaust room (bathroom). Therefore an additional ventilation duct has to be laid from the Freshbox to the exhaust room. Please find the respective parts lists (BlauFast) for connection of the exhaust room on page 15.

The second room can also be equipped with a humidity sensor. This ensures dehumidification of the room by means of the Freshbox 100. The humidity sensor is installed according to the following scheme:

**Optional connection for a second room with humidity sensor in the bathroom**

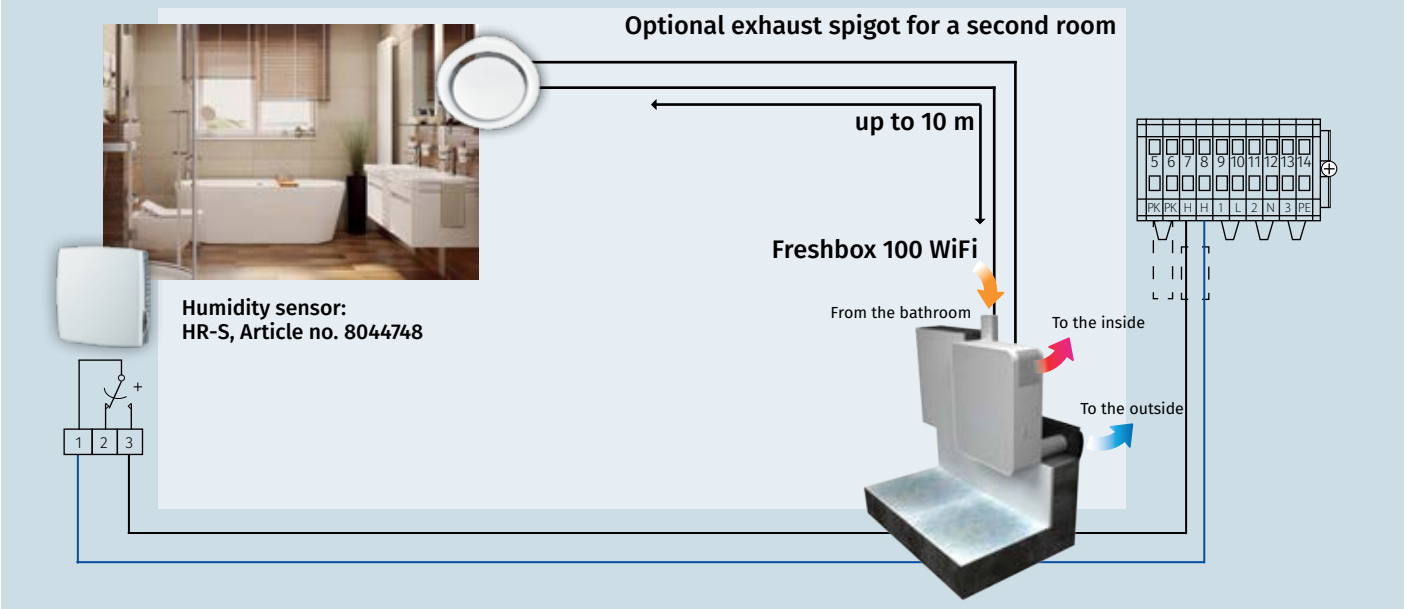

**Connection of a second room:**

**FRESHBOX 100 WIFI MOUNTING EXAMPLE IN THE OFFICE**

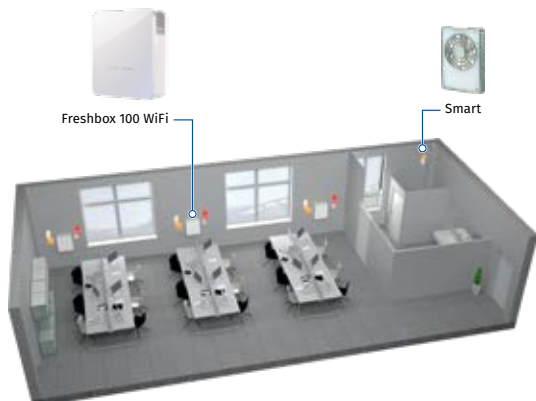

**FRESHBOX 100 WIFI APPLICATION IN A COMPACT RESIDENTIAL SPACE**

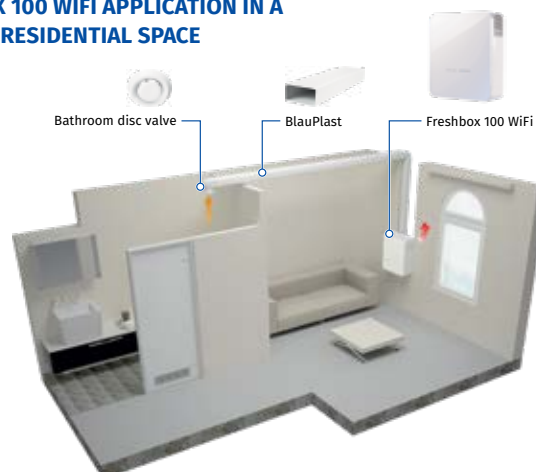

**Blaufast – Order list for connection to a second room with BlauFast ducts**

Product name		Description	Quantity	Article number
BlauPlast US-90° 100/204x60		Adaptor Freshbox - Flat duct	1	8025532
BlauFast MH 75/204x60		Adaptor Flat duct - BlauFast 2x75 mm	1	8028427
BlauFast RK 75/50		BlauFast duct 75 mm, double laying length, two ducts needed for 60 m³/h. Maximum length is 10 metres.	as needed	8029158
BlauFast RPZ 125/75x2 M		Adaptor BlauFast duct – 125 mm duct for valve connection	1	8028045
VMR 125		Diffuser – location where the air enters the duct system	1	8033278
BlauFast RL 75		Sealing ring for BlauFast duct system	4	8023613
BlauFast RD 75		Throttle for BlauFast duct system	2	8023538

**Further accessories**

Product name		Description	Article number
MS Freshbox 100 chrome MS Freshbox 100 white		Mounting kit: • Two Ø100 mm air ducts, 500 mm long • Ventilation outer hood made of polished steel • Cardboard template	8030277 8030284
FP 193x158x18 G4 PPI		G4 panel filter	8029493
FP 193x158x47 F8		F8 panel filter	8029516
FP 193x158x47 F8 C		F8 carbon panel filter	8029523
FP 193x158x47 H13		H13 HEPA panel filter	8029530
HR-S		Humidity sensor	8044748

## CABRIO BASE

Silent and energy saving

### Features

- The casing and the impeller are made of high-quality, durable, UV resistant ABS plastic.
- The fan extract spigot incorporates specially designed air rectifiers to reduce air turbulence and noise level.
- Maintenance-free bearings contain enough lubricant for 40 000 hrs of non-stop operation of the motor.
- The fan is equipped with a special mechanism for smooth opening and closing of the front panel.
- Due to the high ingress protection rating IP44 the fan is the ideal bathroom ventilation solution.
- Also available with interval timer (Cabrio Base V2 T, article number 8046810)

### Technical data

Model	Cabrio Base 100
Voltage [V / Hz]	220-240/50
Power [W]	9
Current [A]	0.059
RPM [min <sup>-1</sup> ]	2160
Air flow [m <sup>3</sup> /h (l/s)]	97 (27)
SFP [W/l/s]	0.33
Sound pressure level [dBA]	25



**Air flow:**  
97 m<sup>3</sup>/h  
27 l/s



**Power:**  
9 W



**Noise level:**  
25 dBA



### Overall dimensions [mm]

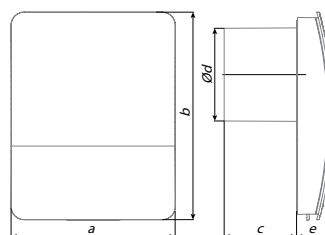

Dimensions [mm]	a	b	c	Ø d	e
Cabrio Base 100	175	221	77	99	39

Product name	Cabrio Base 100	Cabrio Base 100 T	Cabrio Base 100 H
Article number	8037948	8046803	8043697
Discount group	R001	R001	R001
List price	114.00 €	134.00 €	155.00 €

## QUATRO C

Decorative cover

### Features

- Wall and ceiling mounting
- Easy maintenance
- Continuous operation
- Backdraft damper
- Ball bearing motor
- Design: Metallic (Quatro C Platinum), Aluminium (Quatro C Hi-tech), Chrom (Quatro C Hi-tech Chrome), Gold (Quatro C Hi-tech Gold)

### Technical data

Modell	Quatro C 100	Quatro C 125	Quatro C 150
Voltage [V / Hz]	220-240/50	220-240/50	220-240/50
Power [W]	14	16	24
Current [A]	0.085	0.1	0.13
RPM [min <sup>-1</sup> ]	2300	2400	2400
Air flow [m <sup>3</sup> /h (l/s)]	88	167	265
SFP [W/l/s]	0.57	0.34	0.33
Sound pressure level [dBA]	33	34	37



**Air flow:**  
up to 265 m<sup>3</sup>/h  
74 l/s



**Power:**  
from 14 W



**Noise level:**  
from 33 dBA



Platinum



Hi-tech Chrome



Hi-tech



Hi-tech Gold

### Overall dimensions [mm]

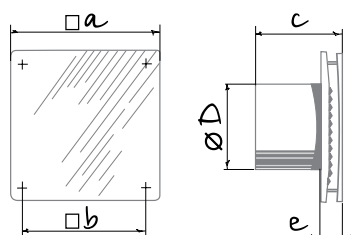

Dimensions [mm]	a	b	c	Ø d	e
Quatro C 100	152	120	126	100	30
Quatro C 125	177	140	135	125	34
Quatro C 150	206	165	154	150	36

Please find the prices for further duct sizes in our price list.

# VALEO-BP & VALEO-E

## Centrifugal fan

### Features

- Exhaust ventilation systems installed in high-rise buildings and premises
- Mono-pipe ventilation systems
- For mounting in kitchens and bathrooms
- Flush wall or ceiling mounting
- Filter with filter class G4 for motor, impeller and ductwork system protection against soiling
- Two-speed motor with a centrifugal impeller. Minimum energy demand.
- Step speed control with an external speed controller, e.g. a CDP-3/5 model which is available upon order.
- Wide range of intellectual controls programmable by set parameters (timer, adjustable timer, internal switch, humidity sensor)



**Air flow:**  
up to 102 m<sup>3</sup>/h



**Power:**  
from 15 W  
**SFP:**  
from 1.04 W/l/s



**Noise level:**  
from 27 dBA



VALEO-BP: unit and casing for flush mounting

VALEO-E: unit and casing for surface mounting

### Mounting

- Flexible air ducts connected to the ductwork system and wiring are routed to the fan through the wall or ceiling.
- After finishing works a flexible air duct is fixed on the fan spigot with clamps.
- Due to the casing (Valeo-BPL, Valeo-BPR, Valeo-BPD), it is possible to connect another duct for exhaust ventilation of an adjacent room (separate order).

### Humidity sensor (Valeo-BP...H und Valeo-E...H):

Depending on wiring connection the fan is off or runs permanently at low speed. The fan switches to higher speed as relative humidity in the room increases from 60 % up to 90 % and switches off as humidity drops by 10 % below the set level. If the light in the room is turned on, the fan switches to higher speed in 50 s. The run-out time is set by the internal regulator from 2 to 30 minutes.

Further variants are available.

### Options

(for two-stage units)

#### Timer (Valeo-BP...T und Valeo-E...T):

Depending on wiring connection the fan is off or runs permanently at low speed. The fan is turned to higher speed with an external switch 50 s after activation. After turning the switch off the fan continues operating within 6 min at higher speed and then reverts to default operation mode.

### Overall dimensions [mm]

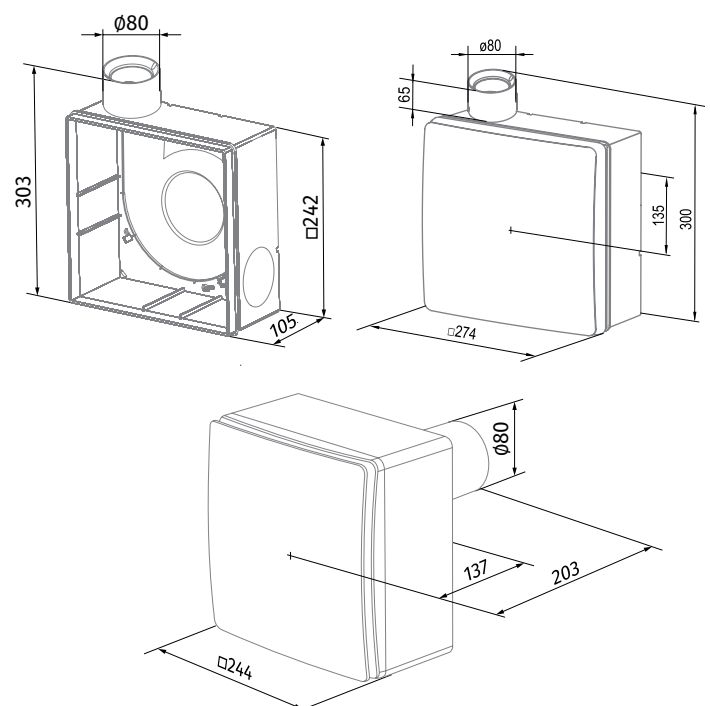

### Technical data

	Valeo-BP/Valeo-E 35/60 H	Valeo-BP/Valeo-E 35/60/100
Speed	I / II	I / II / III
Voltage [V/Hz]	220-240	220-240
Power [W]	15/25	15/25/44
Current [A]	0.12/0.14	0.12/0.14/0.18
Cable cross section [mm <sup>2</sup> ]	3x1.5	4x1.5
Maximum air flow [m <sup>3</sup> /h]	35; 63	35; 63; 102
Sound pressure level at 3 m [dBA]	27/36	27/36/46
Max. transported air temperature [°C]	+50	+50
IP rating	IP55	IP55
Motor protection rating	IP44	IP44

	Valeo-BP 35/60 H	Valeo-E 35/60 H	Valeo-BP 35/60/100	Valeo-E 35/60/100
Article number	8020018	8020209	8006586	8020247
Discount group	R004	R004	R004	R004
List price	214.00 €	214.00 €	194.00 €	194.00 €

# VALEO2

## Single-duct ventilation according to DIN 18017-3

- o **Valeo2 AC:** Fan unit with inner cover for single-duct ventilation according to DIN 18017-3
- o **Valeo2:** Controller for the fan unit
- o **Valeo2 BF:** flush-mounting housing with fire protection for the Valeo2 fan unit
- o **Valeo2 BP2:** flush-mounting housing without fire protection for the Valeo2 fan unit
- o **Valeo2 E2:** surface-mounting housing without fire protection for the Valeo2 fan unit



### Usage

- o For exhaust ventilation of living and sanitary rooms and eat-in kitchens
- o Also available with fire protection housing according to DIBt.
- o The extremely flat housing with an 83 mm installation depth can also be installed in narrow walls and facings.
- o Suitable for flush and surface mounting
- o Integrated timer and humidity sensor
- o Jet-proof according to protection rating class IPX5 and thus admitted for installation in protection area 1 of wet rooms.
- o Can be mounted in different positions and on storey ceilings or in shaft walls
- o Also suited for installation in simple drywalls.
- o Flexible installation depth, as housings and inner cover do not have to be connected
- o Various retrofitting options, even in mounted condition.



**Air flow:**  
up to 60 m<sup>3</sup>/h



**Power:**  
from 7.2 W



**Noise level:**  
from 30 dB(A)

### Design

- o The single-duct fan is designed for exhaust ventilation of windowless bathrooms or/and toilets and eat-in kitchens.
- o The air is being taken in inside the room via a filter and is blown outdoors through a single-duct system. The converted amount of air is 30 or 60 m<sup>3</sup>/h and is determined by corresponding control electronics.
- o Cleaning and filter replacement can be done easily by removal of the attached cover without any tools.
- o Valeo2 can be compiled according to individual needs. This is done in three simple steps:
  1. **Selecting the housing**
  2. **Selecting the fan unit**
  3. **Selecting the attachable controller**
- o Due to the modular design of the fan, a flexible compilation and retrofitting or upgrade to other functions is possible – even when the fan is already mounted.

	Article	Description	Article no.	D G	List price
<b>Housing</b>	Valeo2 BF	Flush-mounted housing with fire protection	8070051	R011	49.50 €
	Valeo2 BFL	Flush-mounted housing with fire protection, additional spigot left	8070068	R011	53.00 €
	Valeo2 BFR	Flush-mounted housing with fire protection, additional spigot right	8070075	R011	53.00 €
	Valeo2 BFK	Flush-mounted housing with self-locking fire protection	8070082	R011	71.00 €
	Valeo2 BFLK	Flush-mounted housing with self-locking fire protection, additional spigot left	8070099	R011	80.00 €
	Valeo2 BFRK	Flush-mounted housing with self-locking fire protection, additional spigot right	8070105	R011	80.00 €
	Valeo2 BP2	Flush-mounted housing without fire protection	8070112	R011	26.00 €
	Valeo2 E2	Surface-mounted housing without fire protection	8070129	R011	50.50 €
<b>Housing accessories</b>	Valeo2 K	Fire protection system for flush-mounted housing Valeo2 BF/BFL/BFR	8070136	R011	35.00 €
	Valeo2 BA	Fire protection system for wall mounting	8070143	R011	46.50 €
	Valeo2 M	Mounting bracket for flush-mounted housing	8070150	R011	15.50 €
<b>Fan unit</b>	Valeo2 AC	Fan motor AC with inner cover	8070167	R011	140.00 €
<b>Controller</b>	Valeo2 30/60	30/60 m <sup>3</sup> /h, without turn-on/turn-off delay	8070181	R011	43.00 €
	Valeo2 30/60 T	30/60 m <sup>3</sup> /h, 60 sec. turn-on delay, 7 min. turn-off delay	8070198	R011	71.00 €
	Valeo2 30/60 ITR	30/60 m <sup>3</sup> /h, adjustable interval and turn-off delay time	8070204	R011	77.00 €
	Valeo2 30/60 H	30/60 m <sup>3</sup> /h, with humidity sensor	8070211	R011	180.00 €
	Valeo2 30/60 IH	30/60 m <sup>3</sup> /h, with interval and humidity sensor	8070228	R011	192.00 €
<b>Accessories</b>	FP Valeo2	Filters, pack of 5	8070242	R011	15.50 €

### Designation key

Model	Speed levels, m <sup>3</sup> /h	Control electronics	Housing	Fire protection	Additional spigot
Valeo2	30/60	<b>T:</b> Turn-on/turn-off delay <b>I:</b> Interval control <b>R:</b> Adjustable turn-off delay <b>H:</b> Humidity sensor	<b>B:</b> Flush-mounted housing <b>E:</b> Surface-mounted housing	<b>F:</b> With fire protection <b>K:</b> With fire protection for eat-in kitchens <b>P2:</b> Without fire protection	<b>L:</b> Additional spigot left <b>R:</b> Additional spigot right



### Fire protection

- To prevent the spreading of fire from floor to floor Valeo2 is also available with fire protection.
- The flush-mounting housings BF and BFK have a shutoff device against fire and smoke according to DIN 18017-3 and fire-resistance class K90.
- There is also the self-locking fire protection system Valeo2 K for eat-in kitchens available.
- The fire protection flap Valeo2 K is also retrofittable when the fan is already mounted.

### Technical data

	Valeo2 AC
Voltage, V/50 (60) Hz	230
Power, W	7.2
Air flow rate, m³/h (l/s)	60
Filter	EU 2
Sound pressure level in 3 m distance, dB(A)	30
Protection rating	IPX5
Article number	8070167

Housing	BP2	BF	BFL/BFR
Material	ABS plastic	Fiber silicate	Fiber silicate
Weight housing, kg	0.5	2.2	2.3

### Overall dimensions [mm]

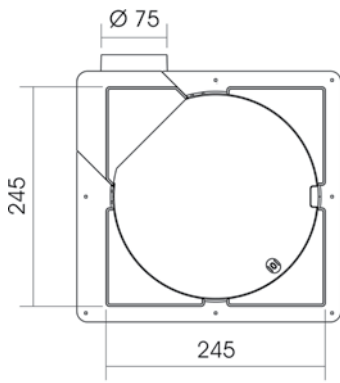

Flush-mounted housing BP2

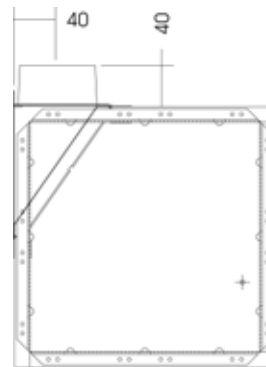
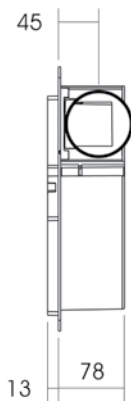

Flush-mounted housing BF

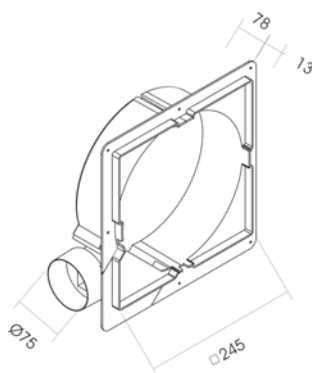
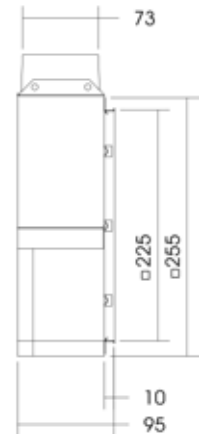

Flush-mounted housing BP2  
perspectively

### Variants



Housing	Valeo2 30/60				
	Basic	T	ITR	H	IH
Speed 1: 30 m³/h	•	•	•	•	•
Speed 2: 60 m³/h	•	•	•	•	•
Humidity sensor				•	•
Timer		•	•	•	•
Adjustable turn-off delay, min.			3-10		
Interval control			•		•
Article number	8070181	8070198	8070204	8070211	8070228

- **Humidity sensor (H)**
  - The sensor automatically determines the humidity of the air and calculates a mean value for a period.
  - As soon as this value is exceeded, the fan starts.
- **Timer (T)**
  - Set turn-on delay of 60 seconds
  - Set turn-off delay of 7 minutes
- **Adjustable turn-off delay (R)**
  - Set turn-on delay of 60 seconds
  - Adjustable turn-off delay of 3-10 minutes
- **Interval control (I)**
  - Adjustable interval from 1-12 hours

# CIVIC EC DB

Single-room air handling units

## Features

- The **CIVIC EC DB** units are designed for single-room ventilation of schools, offices and other public and commercial premises.
- Offer the ideal simple and efficient ventilation solutions for existing and renovated buildings and require no layout of air ducts.
- Efficient supply and extract ventilation for separate premises.
- EC motors with low energy consumption
- Low-noise operation
- Simple mounting



**Air flow:**  
up to 1000 m<sup>3</sup>/h  
278 l/s



**Heat recovery efficiency:**  
up to 93 %



## Design

- Made of high-quality polymer coated steel, internally lined with heat- and sound insulation of mineral wool or other materials.
- Available modifications with an integrated preheater and reheater for cold climate applications.

## Bypass

- The units are equipped with a bypass. The bypass damper opens for free cooling ventilation mode in summer.

## Motors

- High efficient electronically commutated motors with external motor and impeller with forward curved blades. Such motors are the most state-of-the-art energy saving solution.
- EC motors are featured with high performance and total speed controllable range. High efficiency reaching 90 % is the premium advantage of the electronically commutated motors.

## Air dampers

- The automatic supply and extract air dampers are used to prevent uncontrollable air draughts during the unit standstill.

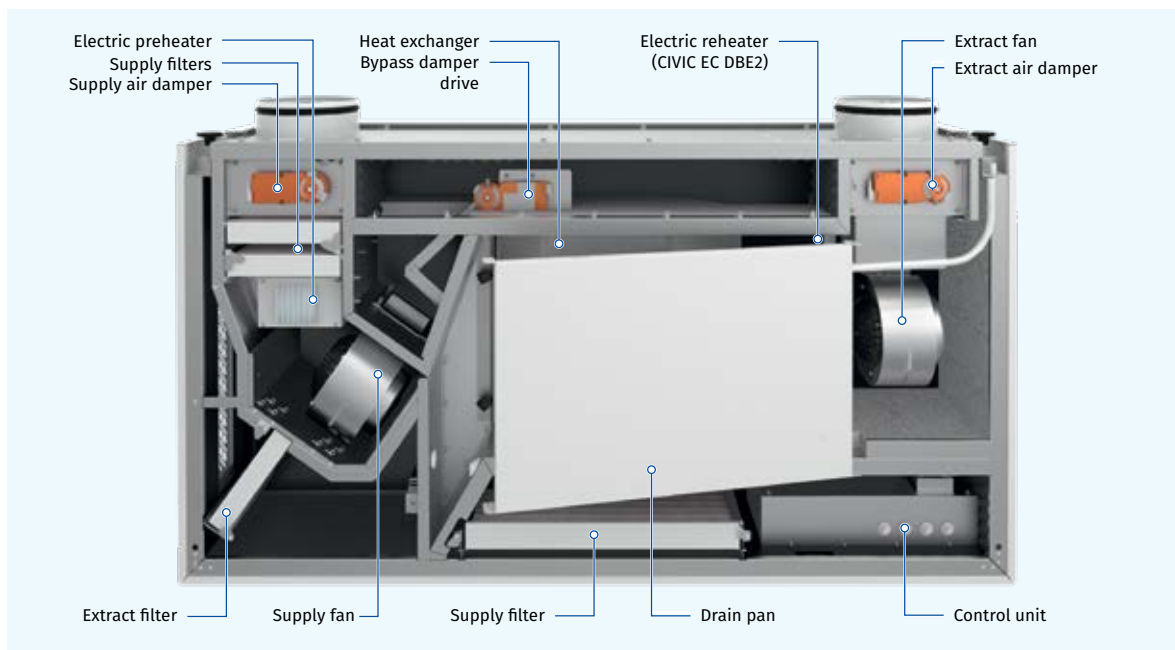

## Designation key

Modell	Motor type	Mounting	Bypass	Heater	Drain pump	Rated air flow [m <sup>3</sup> /h]	Control
CIVIC	<b>EC:</b> synchronous electronically commutated motor	<b>D:</b> Suspended mounting, horizontally oriented spigots <b>D1:</b> Suspended mounting, vertically oriented spigots	<b>B:</b> with bypass	<b>-:</b> without heater <b>E:</b> preheating <b>E2:</b> preheating + reheating	<b>-:</b> without drain pump <b>CP:</b> with drain pump	300; 500; 1000	S21

### Heater

#### PREHEATING

- o **CIVIC EC DBE** and **CIVIC EC DBE2** units are equipped with an electric preheater which protects the heat exchanger from freezing.

#### REHEATING

- o **CIVIC EC DBE2** units feature an electric reheater to raise the supply air temperature.

### Heat exchanger

- o The CIVIC EC DB unit has a counter-flow heat exchanger made of polystyrene.
- o **In cold season** the heat energy of the extract air flow is absorbed by intake air flow, thus decreasing the heat losses caused by ventilation. Condensate generated during heat recovery is collected in a drain pan and removed through the drain pipes to the sewage system.
- o **In warm season** the heat of the outdoor air is absorbed by extract air flow. This way the supply air temperature decreases and heat recovery reduces operation loads for the air conditioner.



### Control

- o The **CIVIC EC DB S21** units are equipped with an integrated automation system.
- o The S21 controller allows integrating the unit into the **BMS (Building Management System)**.
- o The unit can be controlled by the **Blauberg AHU** mobile application via Wi-Fi.



Download the **Blauberg AHU** app for Android



Download the **Blauberg AHU** app for iOS



Also available with **REHEATER**

### Technical data

Parameters	PRE-HEATER		PRE-HEATER		PRE-HEATER	
	CIVIC EC DB 300 S21	CIVIC EC DBE 300 S21	CIVIC EC DB 500 S21	CIVIC EC DBE 500 S21	CIVIC EC DB 1000 S21	CIVIC EC DBE 1000 S21
Voltage [V / 50 (60) Hz]	1~ 230	1~ 230	1~ 230	1~ 230	3~400	3~400
Power consumption without heater(s) [W]	125	125	170	170	260	260
Preheater power consumption [W]	-	1050	-	1750	-	6300
Max. current consumption without heater(s) [A]	1.3	1.3	1.7	1.7	1.85	1.85
Max. current consumption with heater(s) [A]	1.3	7.3	1.7	10.4	1.85	11.2
Maximum air flow [m³/h (l/s)]	300 (83)	300 (83)	510 (142)	510 (142)	1000 (278)	1000 (278)
RPM [min⁻¹]	2150	2150	1700	1700	2070	2070
Sound pressure level at 3 m [dBA]	22	22	24	24	25	25
Max. transported air temperature [°C]	-25 ... +40	-25 ... +40	-25 ... +40	-25 ... +40	-25...+40	-25...+40
Casing material	polymer coated steel	polymer coated steel	polymer coated steel	polymer coated steel	polymer coated steel	polymer coated steel
Insulation	30 mm, polyester	30 mm, polyester	30 mm, polyester	30 mm, polyester	45 mm, polyurethane foam	45 mm, polyurethane foam
Extract filter	G4	G4	G4	G4	G4 x 2	G4 x 2
Supply filter	G4, F8 (option: F8 - Carbon + H11)	G4, F8 (option: F8 - Carbon + H11)	G4, F8 (option: F8 - Carbon + H11)	G4, F8 (option: F8 - Carbon + H11)	G4x2 + (option: F7 x 2)	G4x2 + (option: F7 x 2)
Connected air duct diameter [mm]	200	200	250	250	315	315
Weight [kg]	78	79	126	128	267	271
Heat exchanger type	counter-flow	counter-flow	counter-flow	counter-flow	counter-flow	counter-flow
Heat exchanger material	polystyrene	polystyrene	polystyrene	polystyrene	polystyrene	polystyrene
Heat recovery efficiency* [%]	76 ... 88%	76 ... 88%	74 ... 86%	74 ... 86%	83...93	83...93
SEC class	A	A	A	A	A+	A+
Article number	8071249	8071256	8071270	8071287	8071720	8071737
Discount group	R005	R005	R005	R005	R005	R005
List price	6960.00 €	7360.00 €	8660.00 €	9060.00 €	10460.00 €	11060.00 €

\*Heat recovery efficiency is specified in compliance with EN 13141-8.

This table just shows a selection. The units are for example also available with a reheater. Further info please see [www.blaubergventilatoren.de](http://www.blaubergventilatoren.de).

**EXCURSION**  
to office  
and school  
ventilation

# CIVIC EC LB

Single-room air handling units

## Features

- The **CIVIC EC LB** units are designed for single room ventilation of schools, offices and other public and commercial premises.
- Offer the ideal simple and efficient ventilation solutions for existing and renovated buildings and require no layout of air ducts.
- Efficient supply and extract ventilation for separate premises
- EC motors with low energy consumption
- Low-noise operation
- Simple mounting



**Air flow:**  
up to 1240 m<sup>3</sup>/h  
344 l/s



**Heat recovery efficiency:**  
up to 96 %



## Design

- Made of high-quality polymer coated steel, internally lined with heat- and sound insulation of mineral wool or other materials.
- Built-in preheater and reheater modifications available for cold climate conditions.

## Bypass

- The units are equipped with a bypass. The bypass damper opens for free cooling ventilation mode in summer.

## Motors

- High efficient electronically commutated motors with external motor and impeller with forward curved blades. Such motors are the most state-of-the-art energy saving solution.
- EC motors are featured with high performance and total speed controllable range. High efficiency reaching 90 % is the premium advantage of the electronically commutated motors.

## Air filtration

- Supply and extract air is purified by a set of panel filters. Filtering class depends on the unit model.
- A Panel G4 filter is used for extract air filtration.

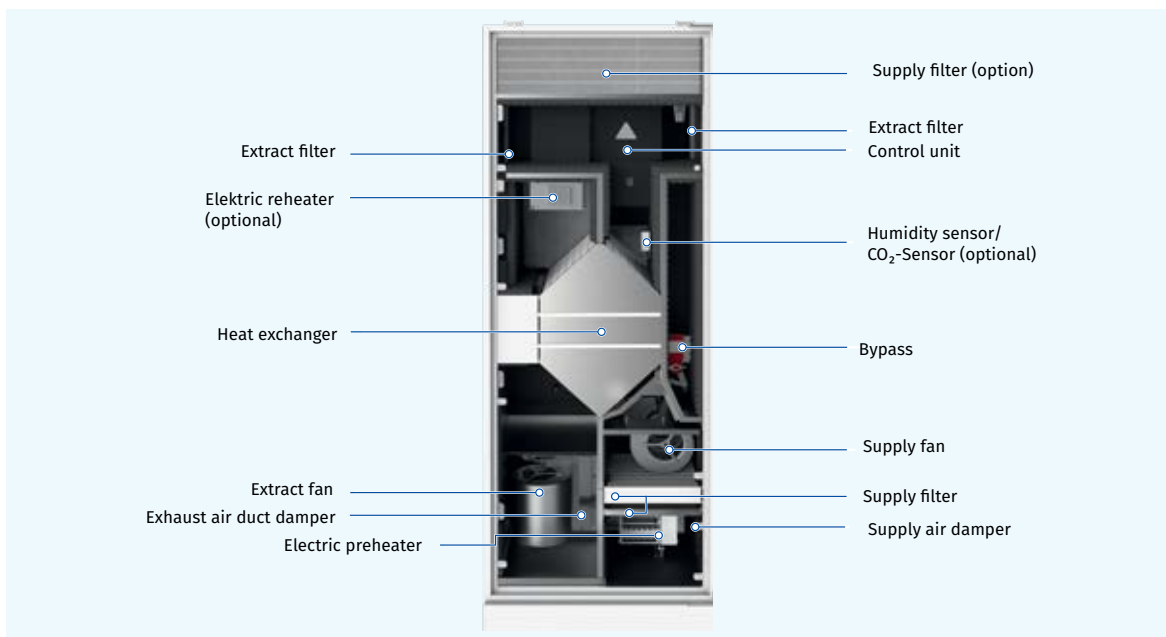

## Designation key

Model	Motor type	Mounting	Bypass	Heater	Drain pump	Rated air flow [m <sup>3</sup> /h]	Heat exchanger type	Control
CIVIC	EC: synchronous electronically commutated motor	L: floor mounting	B: with bypass	_: without heater E: preheating E2: preheating + reheating	_: without drain pump CP: with drain pump	300; 500; 1200	_: heat recovery -: energy recovery	S21 S14

## Heaters

### PREHEATING

- o **CIVIC EC LBE** and **CIVIC EC LBE2** units are equipped with an electric preheater which protects the heat exchanger from freezing.

### REHEATING

- o **CIVIC EC LBE2** units feature an electric reheater to raise the supply air temperature.

## Heat exchanger

- o The **CIVIC EC LB** unit has a counter-flow heat exchanger made of polystyrene.
  - **In cold season** the heat energy of the extract air flow is absorbed by intake air flow, thus decreasing the heat losses caused by ventilation. Condensate generated during heat recovery is collected in a drain pan and removed to the sewage system.
  - **In warm season** the heat of the outdoor air is absorbed by extract air flow. This way the supply air temperature decreases and heat recovery reduces operation loads for the air conditioner.
- o The **CIVIC EC LB... -E** unit is equipped with a counter-flow heat exchanger made of enthalpy membrane.
  - **In cold season** the heat and moisture of the extract air are absorbed by supply air through the enthalpy membrane, thus decreasing the heat losses caused by ventilation.

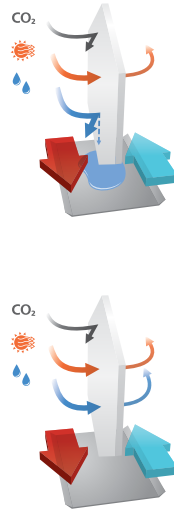

- **In warm season** the heat and humidity of the outdoor air is absorbed by extract air flow through the enthalpy membrane. This way the supply air temperature and humidity decreases and heat recovery reduces operation loads for the air conditioner.



## Control

- o The CIVIC EC LB... S21 units are equipped with an integrated automation system.
- o The S21 controller allows integrating the unit into the **BMS (Building Management System)**.
- o The unit can be controlled by the Blauberg AHU mobile application via Wi-Fi.
- o The **CIVIC EC LB... S14** units are equipped with an integrated automation system and the S14 wall mounted sensor control panel with LED-indication.



Download the **Blauberg AHU** app for Android



Download the **Blauberg AHU** app for iOS



Also available with **REHEATER**

## Technical data

	Civic EC LB 300-E S21 Civic EC LB 300-E S14	Civic EC LBE 300-E S21	Civic EC LB 500 S21 Civic EC LB 500 S14	Civic EC LBE 500 S21	Civic EC LB 1200 S21	Civic EC LBE 1200 S21
<b>Voltage [V / 50 (60) Hz]</b>	1~230	1~230	1~230	1~230	3~400	3~400
<b>Power consumption without heater(s) [W]</b>	125	125	230	230	350	350
<b>Preheater power consumption [W]</b>	-	1400	-	1400	-	6300
<b>Max. current consumption without heater(s) [A]</b>	0.9	0.9	1.7	1.7	1.6	1.6
<b>Max. current consumption with heater(s) [A]</b>	0.9	7	1.7	7.8	1.6	9.6
<b>Maximum air flow [m<sup>3</sup>/h (l/s)]</b>	320 (89)	320 (89)	580 (161)	580 (161)	1240 (344)	1240 (344)
<b>RPM [min<sup>-1</sup>]</b>	2150	2150	1280	1280	3630	3630
<b>Sound pressure level at 3 m [dBA]</b>	21	21	23	23	24	24
<b>Transported air temperature [°C]</b>	-25...+40	-25...+40	-25...+40	-25...+40	-25...+40	-25...+40
<b>Casing material</b>	polymer coated steel	polymer coated steel	polymer coated steel	polymer coated steel	polymer coated steel	polymer coated steel
<b>Insulation</b>	40 mm, mineral wool	40 mm, mineral wool	40 mm, mineral wool	40 mm, mineral wool	40 mm, mineral wool	40 mm, mineral wool
<b>Extract filter</b>	G4 x 2	G4 x 2	G4 x 2	G4 x 2	G4	G4
<b>Supply filter</b>	G4 + F8 (option: F8 - Carbon + H11)	G4 + F8 (option: F8 - Carbon + H11)	G4 + F8 (option: F8 - Carbon + H11)	G4 + F8 (option: F8 - Carbon + H11)	G4 + (option: F7)	G4 + (option: F7)
<b>Connected air duct diameter [mm]</b>	200	200	250	250	400	400
<b>Weight [kg]</b>	136±3%	137±3%	191±3%	193±3%	394	398
<b>Heat exchanger type</b>	counter-flow	counter-flow	counter-flow	counter-flow	counter-flow	counter-flow
<b>Heat exchanger material</b>	enthalpic membrane	enthalpic membrane	polystyrene	polystyrene	polystyrene	polystyrene
<b>Heat recovery efficiency* [%]</b>	73...89 %	73...89 %	75...94 %	75...94 %	84...96 %	84...96 %
<b>SEC class</b>	A	A	A	A	A+	A+
<b>Article number</b>	S21: 8071508 S14: 8059100	8071515	S21: 8071218 S14: 8059346	S21: 8071225	8073526	8073533
<b>Discount group</b>	R005	R005	R005	R005	R005	R005
<b>List price</b>	S21: 7200.00 € S14: 5550.00 €	7600.00 €	S21: 8260.00 € S14: 6300.00 €	8660.00 €	12310.00 €	13110.00 €

\*Heat recovery efficiency is specified in compliance with EN 13141-8.

This table just shows a selection. The units are for example also available with a reheater. Further info please see [www.blaubergventilatoren.de](http://www.blaubergventilatoren.de).



## COMPLEMENTARY AND ALTERNATIVE ACCESSORIES

### REDUCING SLEEVE FOR EXHAUST FANS (160/100)

The reducing sleeve can be inserted subsequently into the shell installation block. The diameter of the air duct can be reduced from 160 mm to 100 mm after the shell construction phase and thus enables mounting of a supply/extract fan with a connection diameter of 100 mm.

The reducing sleeve can be adapted to the wall thickness by cutting it to the required size.



The reducing sleeve is made from EPS and can be installed after the shell construction phase into the already walled in shell installation block without further tools. Due to the shell installation block no core hole is needed. This saves several working steps and has the following advantages:

- No core hole required and thus a clean installation
- No subsequent foaming necessary
- Higher insulation of the air duct



Reducing sleeve inserted into the shell installation block



Fan with reducing sleeve inserted into the shell installation block

The reducing sleeve is inserted flush into the shell pre-installation block. The required slope for condensate drainage is already taken into account with the installation of the shell installation block.

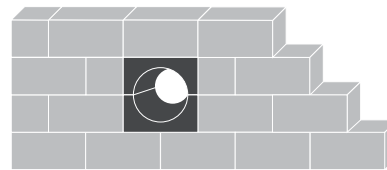

Wall

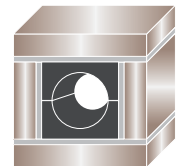

wooden rack in wooden constructions

The reducing sleeve is applicable for the following models:

- All supply and extract fans with a connection diameter of 100 mm
- VENTO Expert A30 W V.2

#### Technical data

Product name	Article number	Discount group	List price
Reducing sleeve	7155043	R005	31.50 €

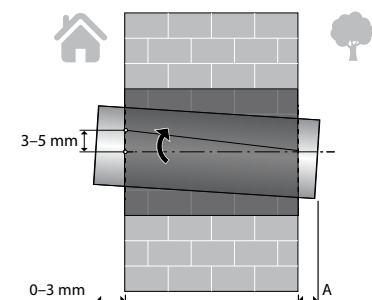

#### Overall dimensions [mm]

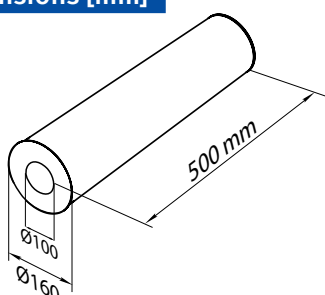

## SHELL INSTALLATION BLOCK

Instead of preparing a core hole, the air duct of the VENTO unit can also be installed into the wall using the shell installation block 365 and shell installation block 500 with a 3 mm slope.

The shell installation block, made from EPS (expanded polystyrol), is installed into the wall during the shell construction phase. Thus a subsequent core hole is redundant, several working steps are saved and the following advantages are provided: no drilling and subsequent foaming is needed. In addition, a higher insulation is obtained.

The shell installation block can be adapted to the wall thickness. From a wall thickness of 500 mm two shell pre-installation block are combined.

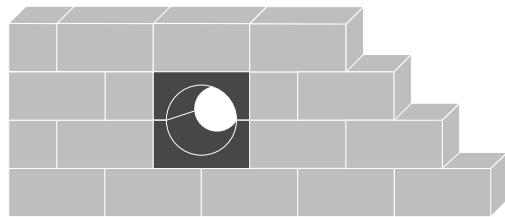

Shell installation block, built into a stone wall.

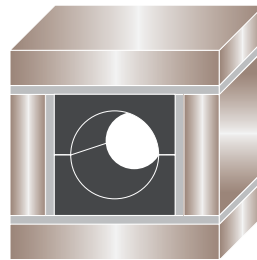

Shell installation block, applied in a wood frame construction.

Shell installation block	Shell installation block 365	Shell installation block 500 with integrated slope
Article number	7055024	8069796
Discount group	R005	R005
List price	26.30 €	63.00 €
Applicable for the models	VENTO Expert A50-1 Pro, VENTO Expert A50-1 S10 W V.2, VENTO Expert Duo A30-1 Pro, VENTO Expert DUO A30-1 S10 W V.2, VENTO Eco A50	

## BASEMENT PENETRATION PIPE VENTO KD 160

The basement penetration pipe enables the installation of VENTO Expert units into basement rooms. A duct with a condensate drain with an integrated check valve and a decorative weather protection hood from stainless steel. The basement penetration pipe can be used up to a maximum distance of 350 mm between the basement ceiling and the top edge of the ground. Upon request, the basement penetration pipe can be equipped with a sensor that measures the difference between the humidity of the inside and the outside to regulate the inside humidity. This is especially relevant, when there is no heat recovery ventilation in the basement rooms. More details can be requested at [service@blaubergventilatoren.de](mailto:service@blaubergventilatoren.de)

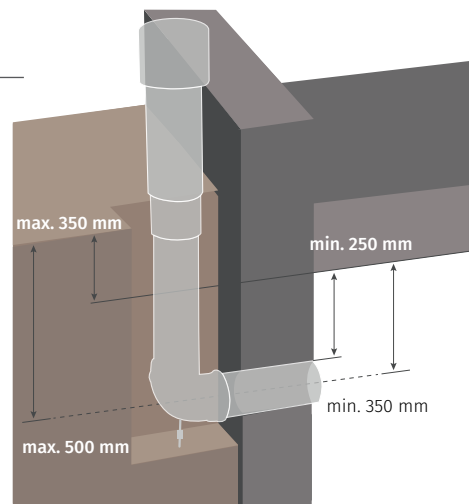

**NEW**

With a check valve



Duct with condensate drain with an integrated check valve and weather protection hood from stainless steel

Product name	VENTO KD 160
Article number	7055029
List price	on request
Applicable for the models	VENTO Expert A50-1 Pro/W, VENTO Eco A50

## ROOF PENETRATION PIPE VENTO DD 160

With the roof penetration pipe VENTO DD 160 it is possible to install your decentral ventilation system also into the attic floor. Due to a variety of colours you can adapt the hood perfectly to your roof colour. For the installation, a flap tile of at least 500 mm is required.

Suitable for roof slopes from 16° to 65°.

The hood of the roof penetration pipe can be adapted individually to the colour of the roof shingle.

<b>Product name</b>	<b>VENTO DD 160</b>
<b>Article number</b>	7077001
<b>List price</b>	on request
<b>Applicable for the models</b>	VENTO Expert A50-1 Pro, VENTO Expert A50-1 S10 W V.2, VENTO Eco A50

### Technical data

VENTO Expert Pro with DD 160	1	2	3
<b>Maximum air flow [m<sup>3</sup>/h]</b>	7.5	15	25
<b>Power [W]</b>	4.6	4.9	6.2
<b>Heat recovery efficiency [%]</b>	up to 92 %		

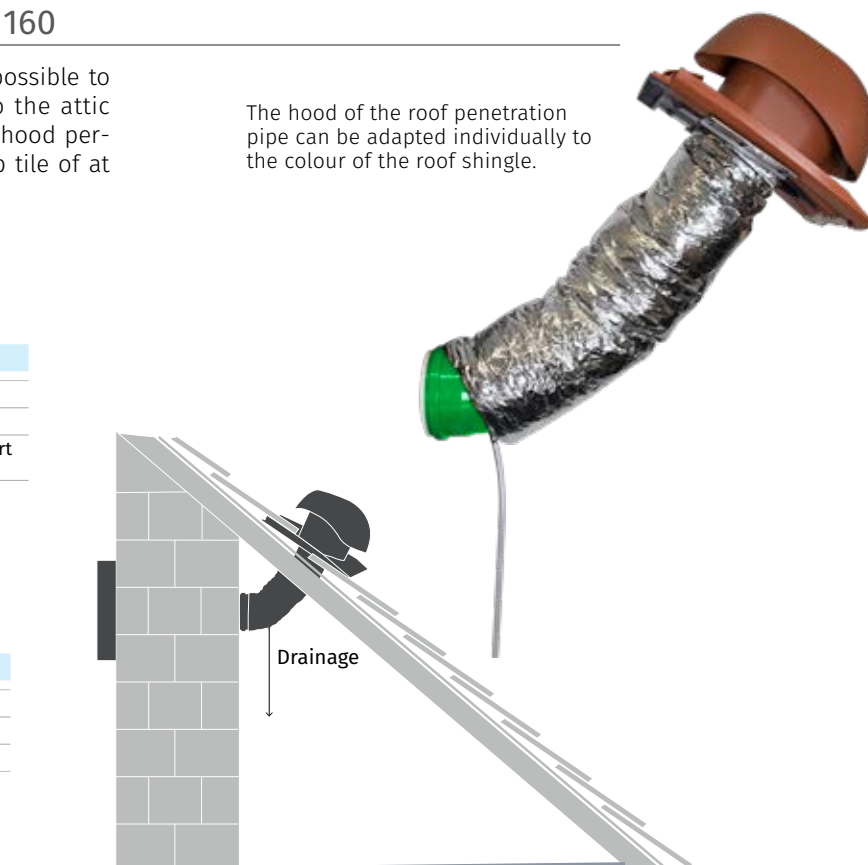

## FILTER – F8 FOR ALLERGY SUFFERERS

As standard, our decentral ventilation units are equipped with two G3 or G4 filters. For VENTO Expert units and the Freshbox a F8 pollen filter is available optionally. This enables allergy sufferers to have a sleep free of complaints in summer, without having to do without fresh air. It should be considered that due to the high density of the filters the air flow rate is reduced by ca. 20 %.



Product name	FP VENTO Expert A50 F8	FP 193x158x47 F8 (Freshbox 100)
<b>Article number</b>	8001420	8029516
<b>Discount group</b>	R012	R012
<b>List price</b>	27.00 €	30.00 €

## SENSORS

### SENSOR TECHNIQUE

You can additionally equip your units with CO<sub>2</sub> sensors. The ventilation units then ventilate automatically, when the CO<sub>2</sub> content exceeds the set threshold value.

Product name	CD-1	CD-2
<b>Article number</b>	8014406	8014413
<b>Discount group</b>	R009	R009
<b>List price</b>	450.00 €	423.00 €



## SOLUTIONS FOR THE OUTSIDE

### AH-10 (DUO) – PLASTIC OUTER HOOD

Cost-saving and with a subtle design. The budget solution for our VENTO units, made from UV-resistant plastic. With a diameter of 100 mm, suitable for many domestic fans. The specifically designed drip edge ensures that occurring condensate can drip off without touching the wall.



- white; RAL 9016
- chrome (stainless steel)
- black
- grey
- anthracite; RAL 7016
- brown; RAL 8017

Product name	AH-10 white 100	AH-10 chrome 100	AH-10 anthracite 100	AH-10 grey 100	AH-10 black 100
Article number	8049910	8049927	8066962	8062612	8063862
Discount group	R003	R003	R003	R003	R003
List price	42.60 €	64.40 €	86.20 €	42.60€	41.00€

Product name	AH-10 white 125	AH-10 chrome 125	AH-10 anthracite 125	AH-10 grey 125
Article number	8050565	8050572	8062629	8066979
Discount group	R003	R003	R003	R003
List price	42.60€	64.40€	42.60€	96.00 €

Product name	AH-10 white 160	AH-10 chrome 160	AH-10 anthracite 160	AH-10 grey 160	AH-10 black 160	AH-10 brown 160
Article number	8049934	8049941	8066832	8056406	8056413	8063831
Discount group	R005	R005	R005	R005	R005	R005
List price	47.30 €	71.40 €	92.40 €	47.30	47.30 €	47.30 €

Product name	AH-10 white 160 DUO	AH-10 chrome 160 DUO	AH-10 anthracite 160 DUO	AH-10 grey 160 DUO	AH-10 black 160 DUO
Article number	8058608	8058615	8066986	8058639	8058622
Discount group	R005	R005	R005	R005	R005
List price	47.30 €	71.40 €	92.40€	47.30 €	43.70 €

### AH 160 – THE CLASSIC, AVAILABLE IN MANY COLOURS

We enhanced the range of colours so that the ventilation unit can be adapted best possible to your construction project.

Product name	AH white 160	AH chrome 160	AH anthracite 160	AH grey 160	AH brown 160
Article number	8020414	8020360	8050930	8027994	8029837
Discount group	R005	R005	R005	R005	R005
List price	93.50 €	136.00 €	93.50 €	93.50€	93.50€



- white; RAL 9016
- chrome (stainless steel)
- grey; RAL 7040
- anthracite; RAL 7016
- brown; RAL 8017



## AH-S – FOR THIN WALLS

If the wall thickness is less than 240 mm, this can be compensated with a special outer hood. The S-variant is available in chrome and grey and requires a wall thickness of just 150 mm.

Product name	AH-S white 160	AH-S chrome 160
Article number	8030659	8020445
Discount group	R005	R005
List price	167.00 €	178.00 €

## FOR WINDOW REVEALS – KIT BLAUPLAST

This kit for window reveals enables the regulation of the air outflow through the window. This is especially relevant, if, for optical reasons, one does not want to install any outer hoods. Available in the colours chrome and white.

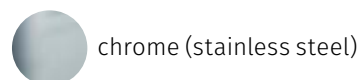

Product name	KIT BlauPlast chrome	KIT BlauPlast white
Article number	8042423	8001277
Discount group	R005	R005
List price	54.60 €	46.20 €
Suitable for the following models	VENTO Expert A50-1 Pro/W, VENTO Eco A50	



## AH CIVIC

Outer hood, made from polished stainless steel, chrome:

Product name	AH CIVIC 300 LB	AH CIVIC 500 LB	AH CIVIC 1200 LB
Article number	8052866	8052880	8073892
Discount group	R005	R005	R005
List price	179.00 €	216.00 €	268.00 €

Outer hood, made from painted stainless steel, white:

	AH CIVIC 300 LB	AH CIVIC 500 LB	AH CIVIC 1200 LB
Article number	8052873	8052897	8073175
Discount group	R005	R005	R005
List price	137.00 €	163.00 €	247.00 €







**Blauberg Ventilatoren GmbH**

Aidenbachstr. 52 · D-81379 Munich

+49 89 785 08 088 · [info@blaubergventilatoren.de](mailto:info@blaubergventilatoren.de)

[www.blaubergventilatoren.de](http://www.blaubergventilatoren.de)

[www.einzelraumlueftung.de](http://www.einzelraumlueftung.de)

Technical changes reserved.  
Illustrations and texts are non-binding.

06/2021

June 2021  
Article no. 2030004